

eduard
Express Mask

XT 028

IS-2m Tactical Marking

A die-cut mask for accurate painting of markings

1/35 scale

THE MASK IS OPTIMIZED FOR USE WITH THE DRAGON OR ZVEZDA KIT

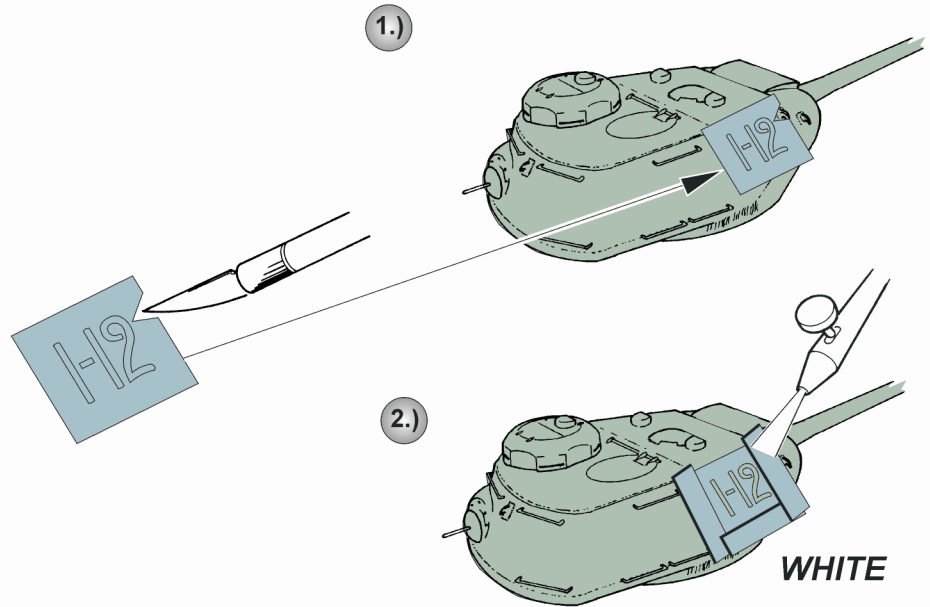
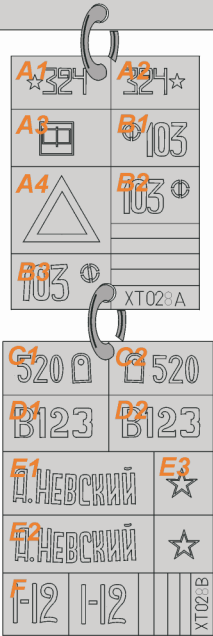

OPTION :

<p>1.</p> <p>CAMOUFLAGE COLOR</p>	<p>2.</p>	<p>3.</p> <p>WHITE</p>	<p>4.</p>
<p>1.</p> <p>WHITE</p>	<p>2.</p>	<p>3.</p> <p>CAMOUFLAGE COLOR</p>	<p>4.</p>

A
UNKNOWN UNIT,
PRAGUE, MAY 1945
 USE **A2** FOR OPPOSITE SIDE

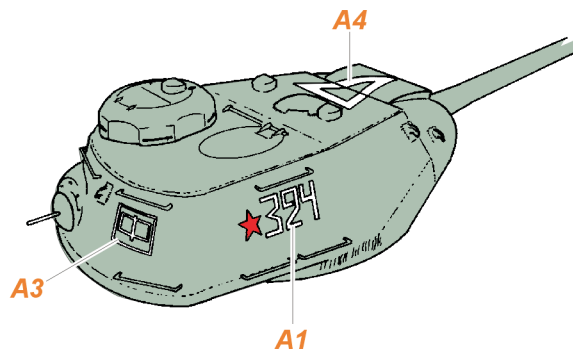

B
57th GUARD HEAVY TANK REGIMENT,
3rd GUARD TANK ARMY,
BERLIN, APRIL 1945
 USE **B2** FOR OPPOSITE SIDE

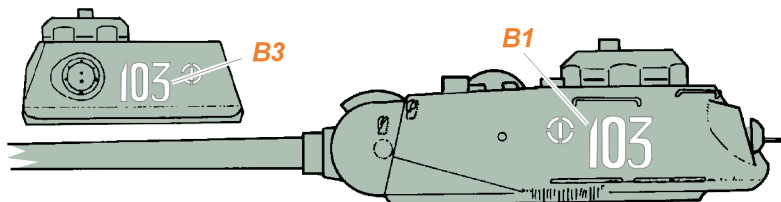

C1
62nd GUARD HEAVY TANK REGIMENT,
8th GUARD TANK CORPS,
DANZIG, MARCH 1945
 USE **C2** FOR OPPOSITE SIDE

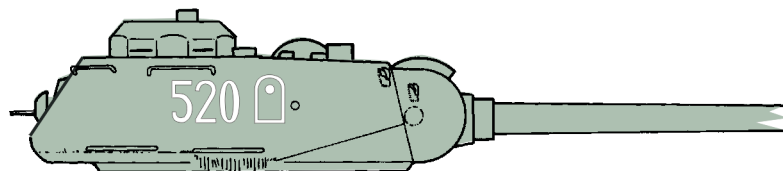

D1
UNKNOWN UNIT,
BERLIN, APRIL 1945
 USE **D2** FOR OPPOSITE SIDE

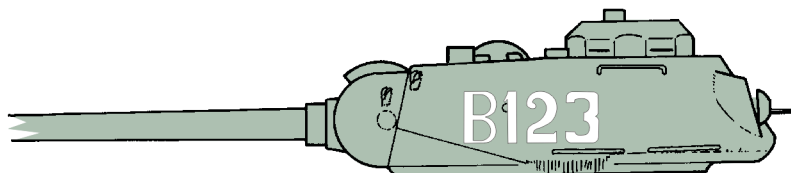

E
UNKNOWN UNIT,
DANZIG, MARCH 1945
 USE **E2** FOR OPPOSITE SIDE

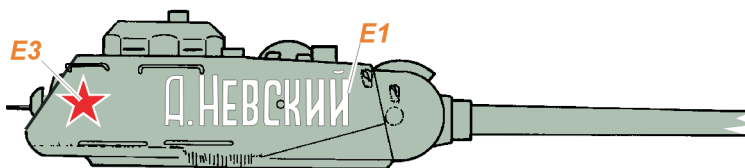

F
26th GUARD HEAVY TANK REGIMENT,
1st UKRAINIAN FRONT,
CZECHOSLOVAKIA, MAY 1945

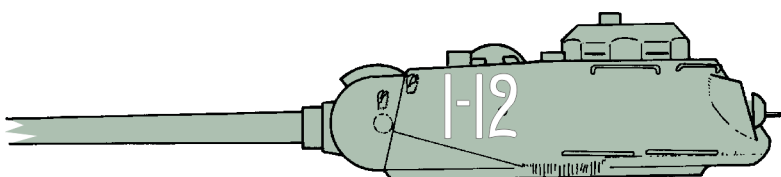

References: -Concord Publ. : Stalin´s Heavy Tanks 1941-45
 -Armada No.5. : IS Tanks
 -Bronkolekcia 3/98 : IS-2
 -Osprey Military : IS-2 Heavy tank 1944-73
 -HaPM 8/1999