

**eduard**  
**Express Mask**

**XS 550**

# Wellington Camo. scheme B

The die-cut mask for accurate painting of the

**1/72 KIT**

THESE MASKS ARE UTILIZED FOR USE WITH THE MPM KIT

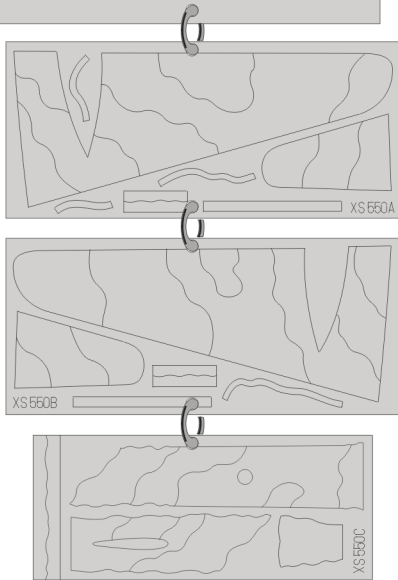

**REFERENCES:**

- Replika #19
- Replic #79/1998
- Flypast #12/1996

**3.)**

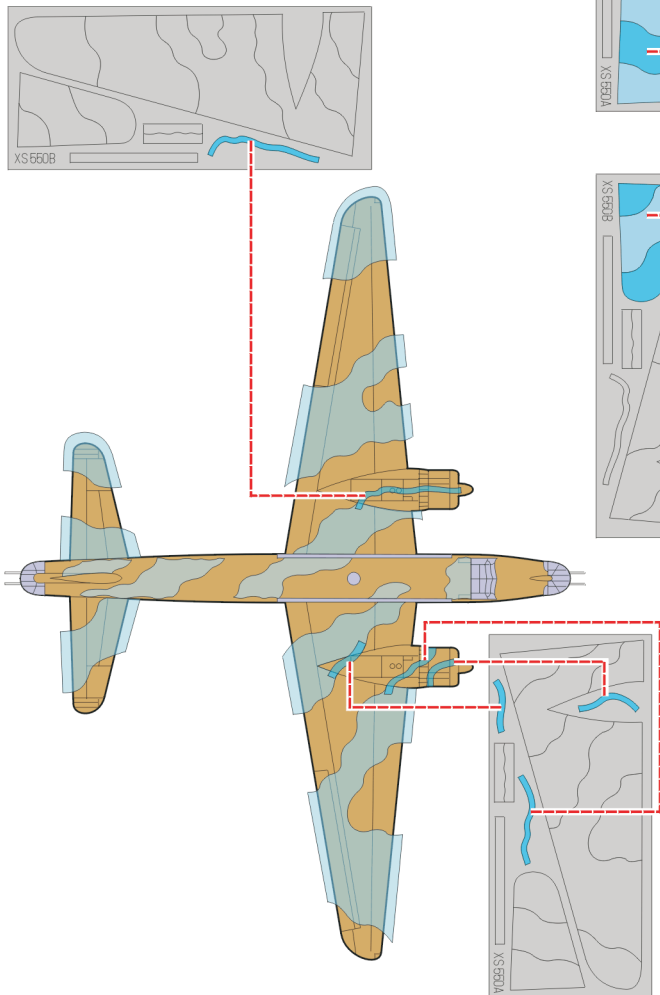

**1.)**

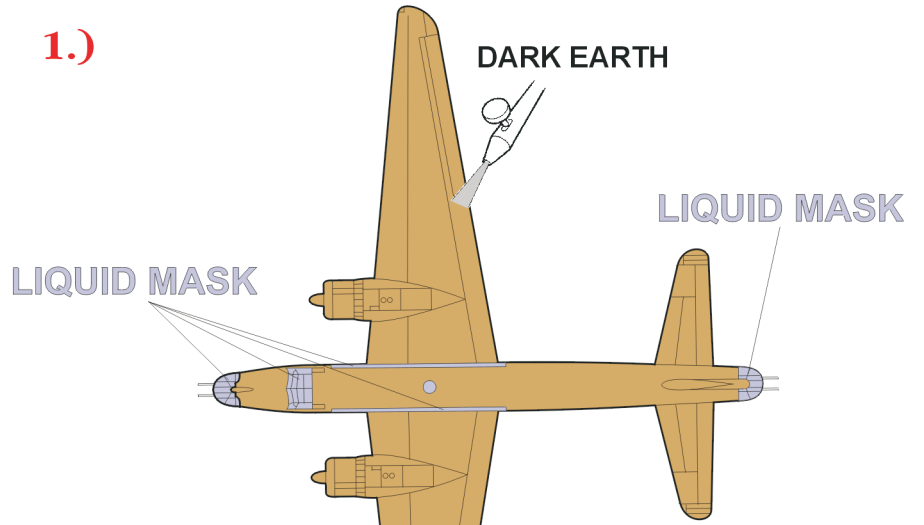

**2.)**

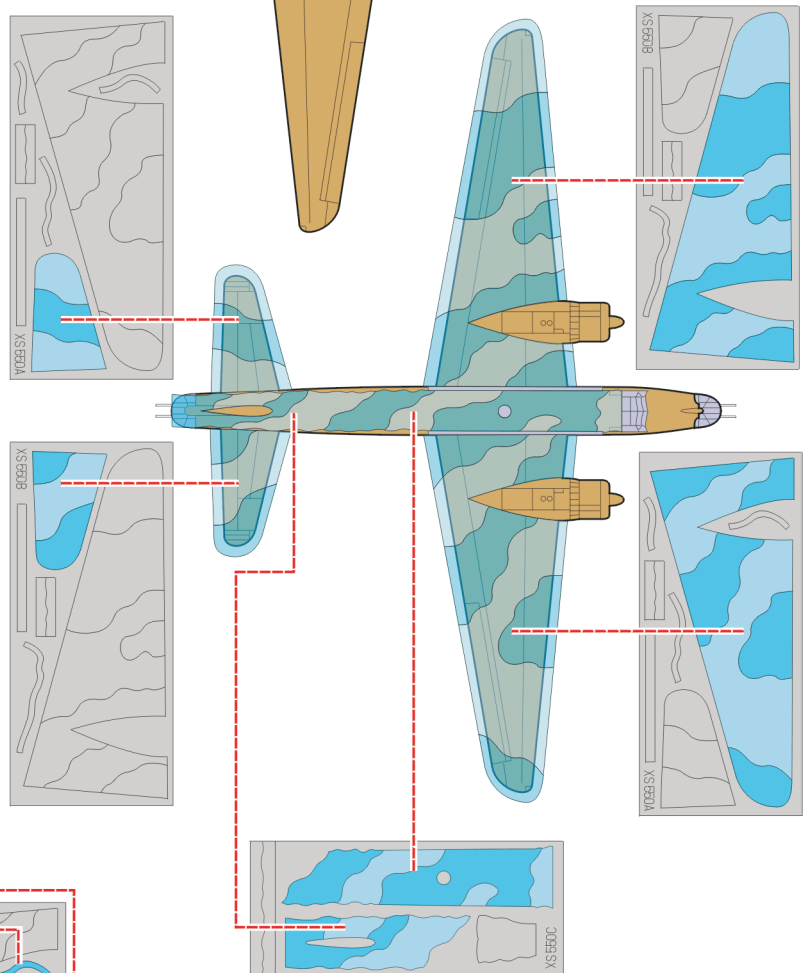

4.)

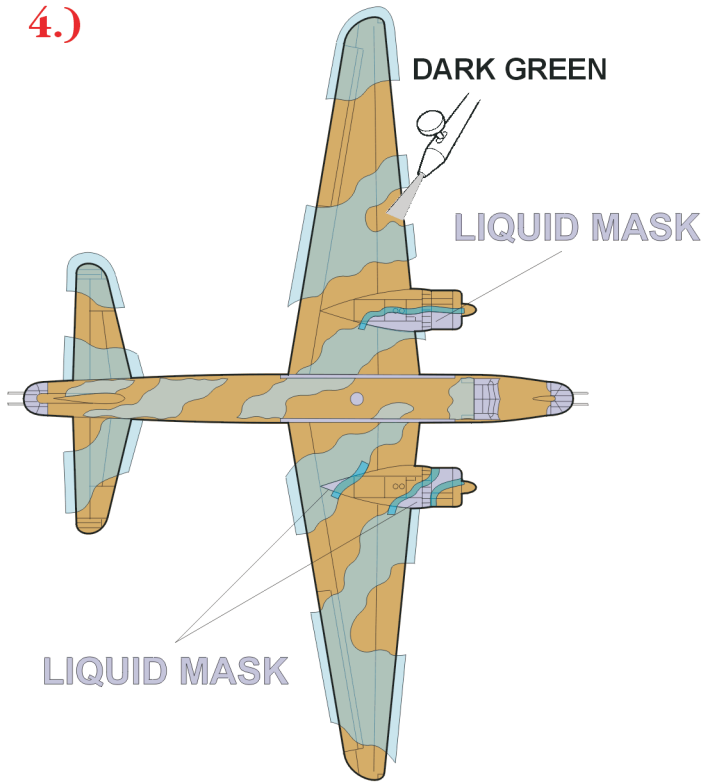

5.)

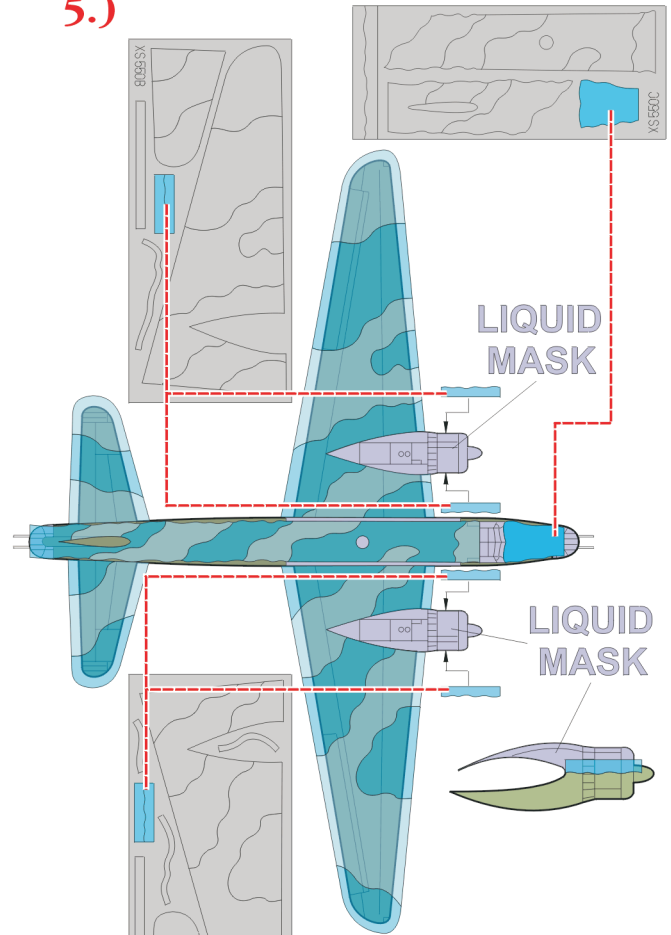

5.)

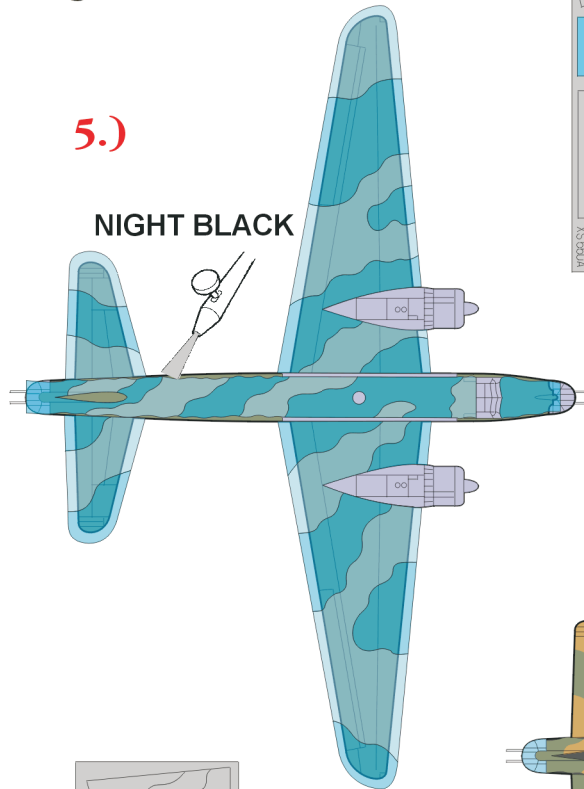

6.) REMOVE MASK

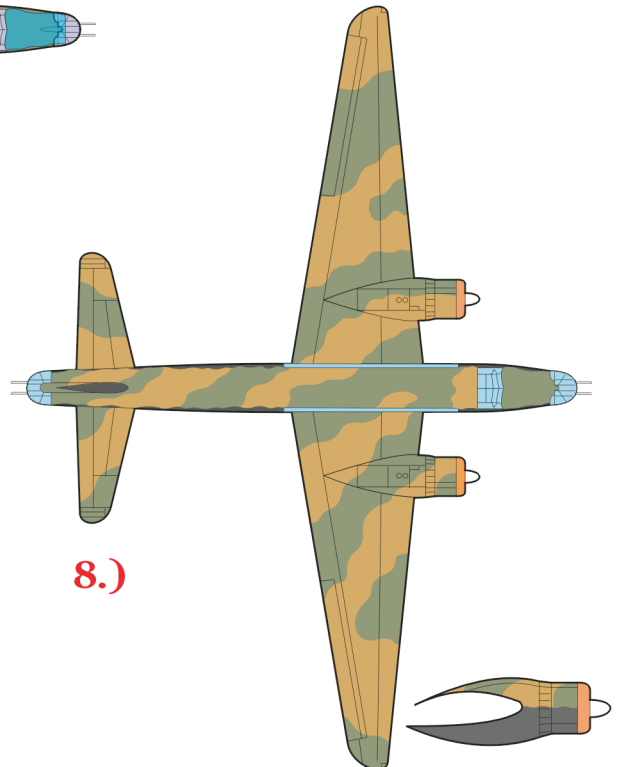

7.)

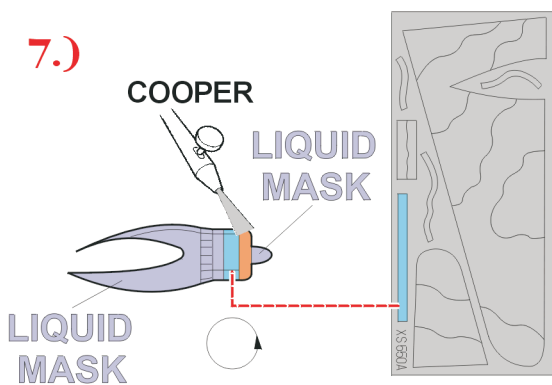

Look for other Express Mask set XS 195 and detail sets 72 388, 72 390 and 72 392 for Wellington (not included in this set)