

eduard
Express Mask

XS 162

Ki - 49 Helen

The die-cut mask for accurate canopy frame painting of the
Hasegawa 1/72 KIT

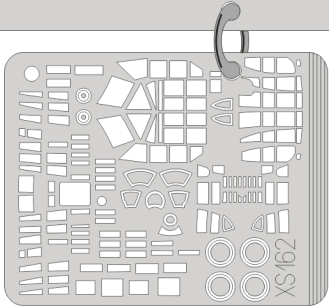

J 9

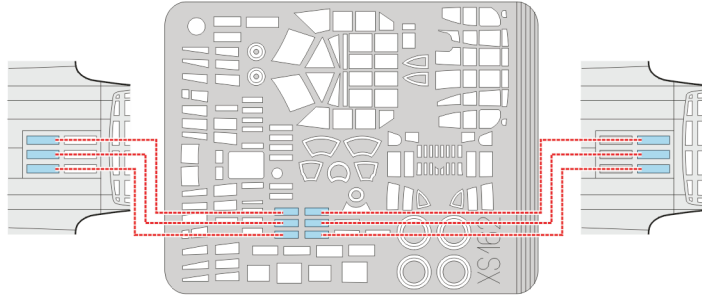

J 3

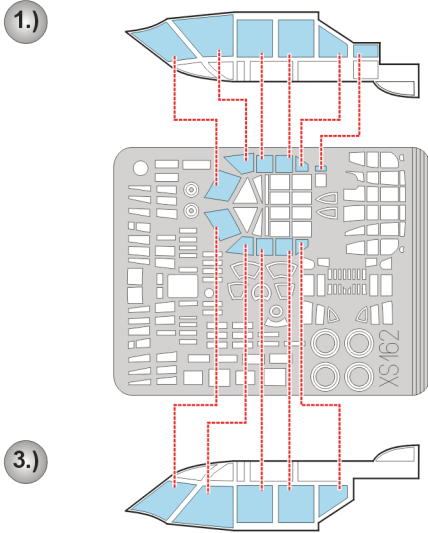

2.)

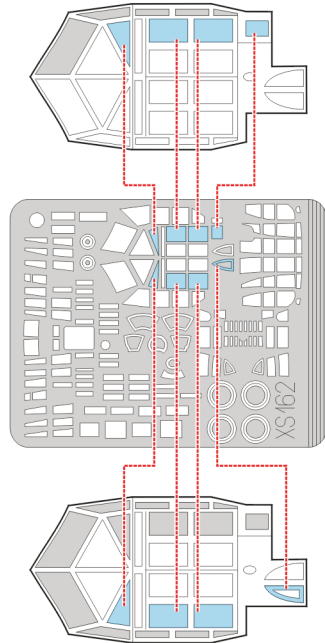

J 3

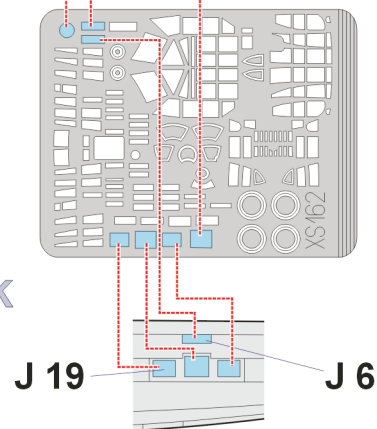
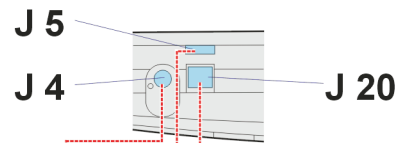
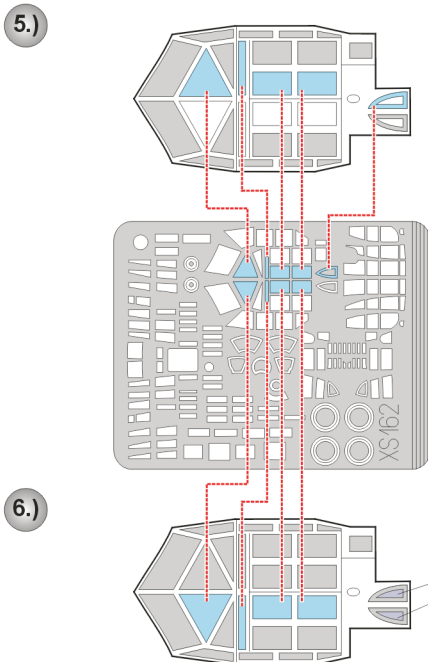

eduard
Express Mask

XS 162

Ki - 49 Helen

The die-cut mask for accurate canopy frame painting of the
Hasegawa 1/72 KIT

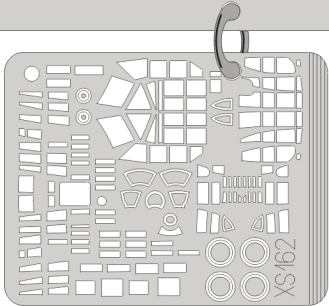

J 9

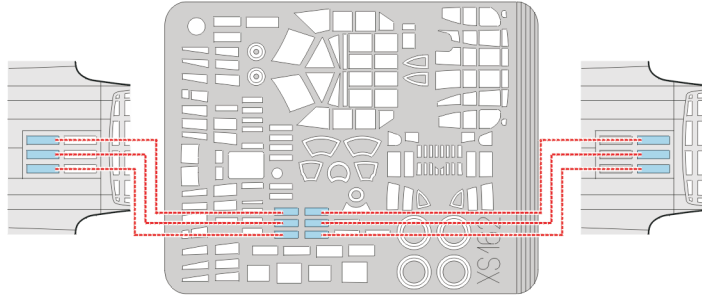

J 3

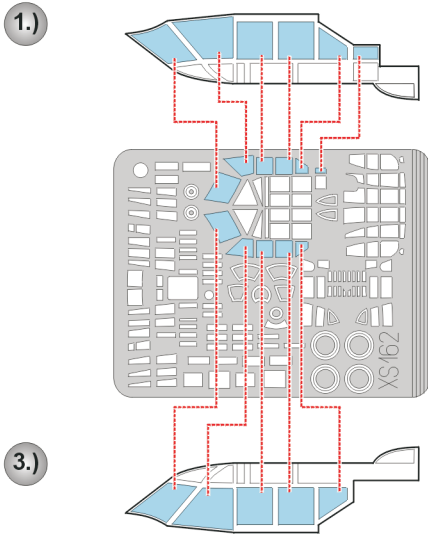

2.)

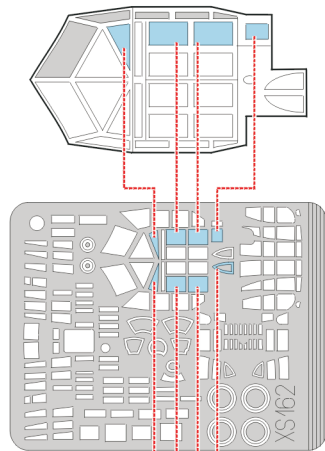

3.)

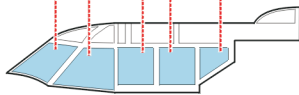

4.)

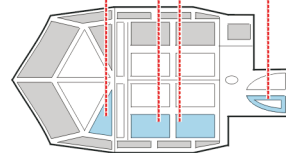

J 3

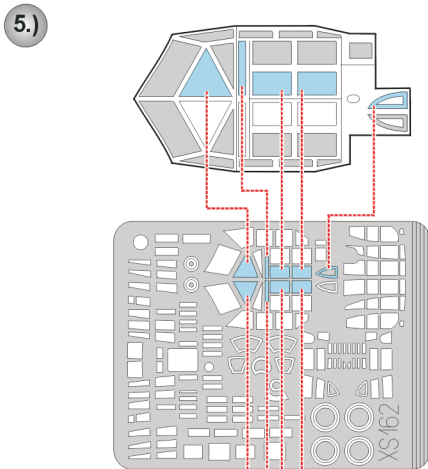

6.)

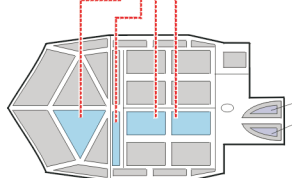

LIQUID MASK

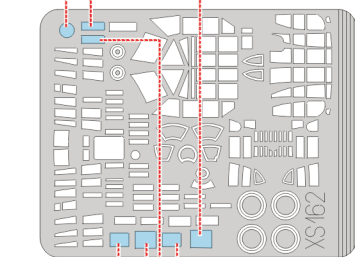
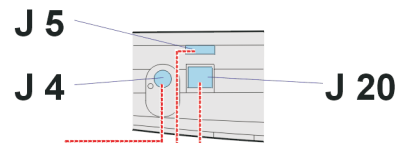

J 19

J 6

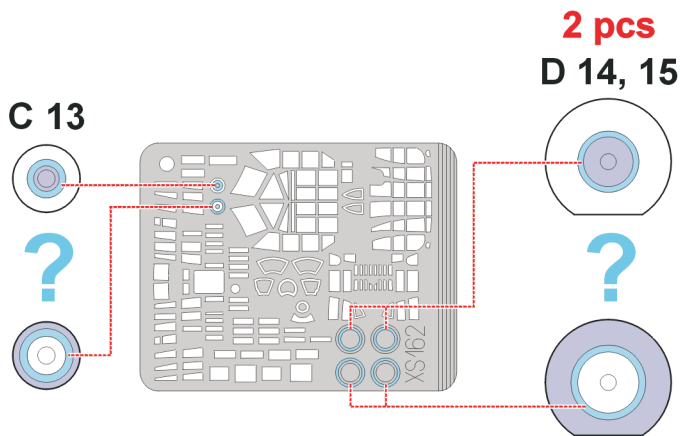
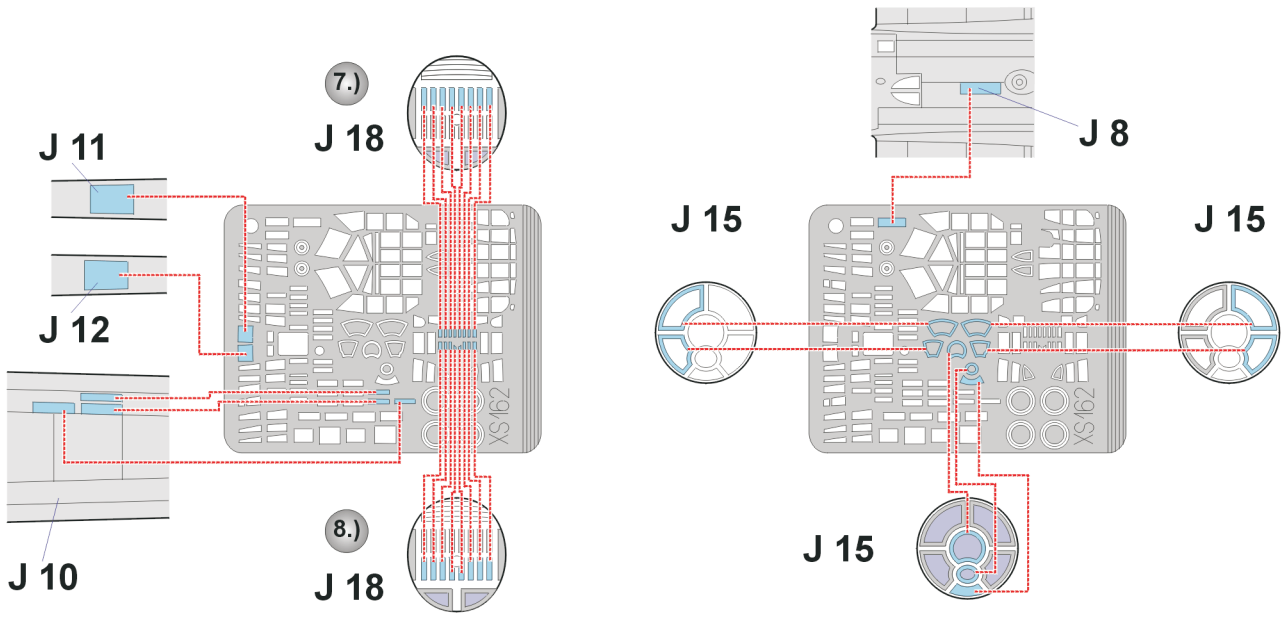
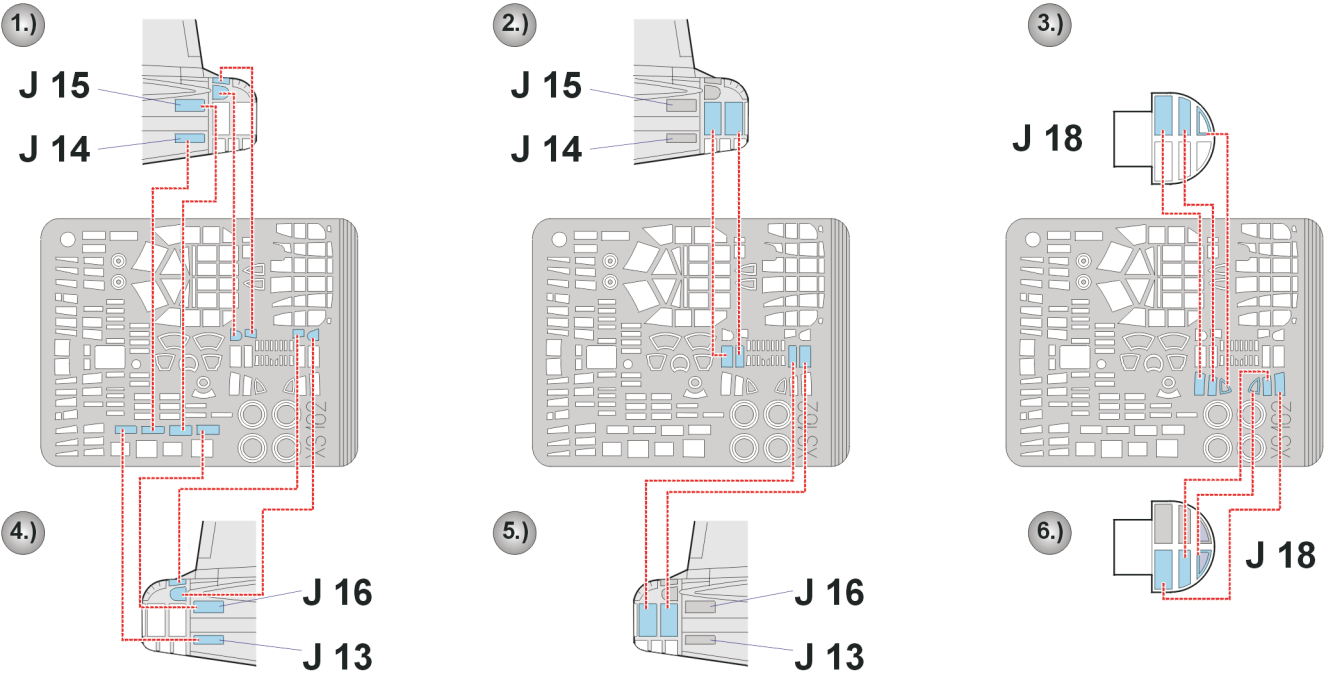

LIQUID MASK

REFERENCES:

Nakajima Ki-49 DONRYU in JAAF Service
Richard M. Bueschel