

eduard
Express Mask

XS 151

A-7D/E Corsair II

The die-cut mask for accurate canopy frame painting of the
Fujimi 1/72 KIT

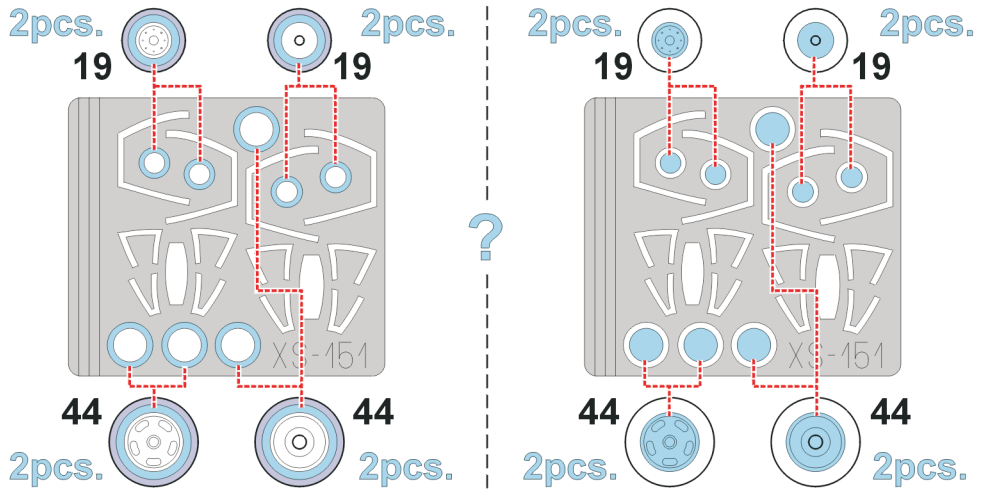

REFERENCES:

Squadron/Signal Publ.: in action A-7 Corsair II

LIQUID MASK

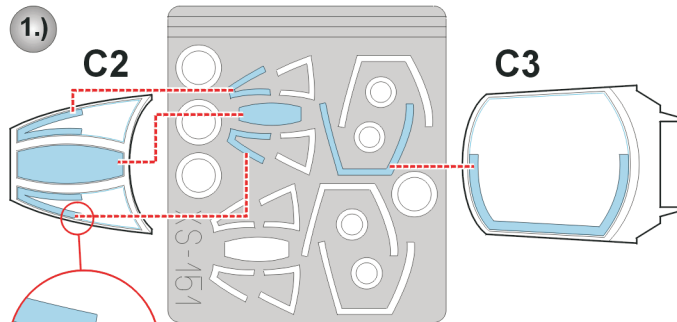

3.) **INTERIOR COLOR**

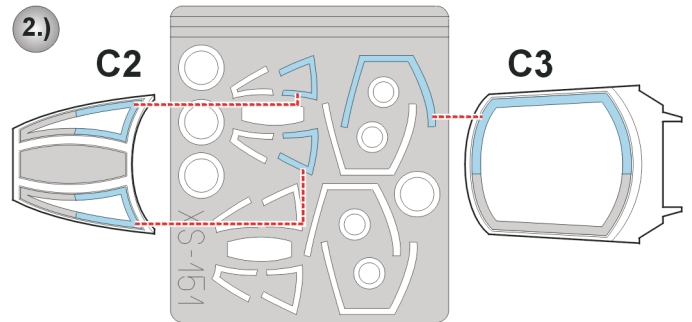
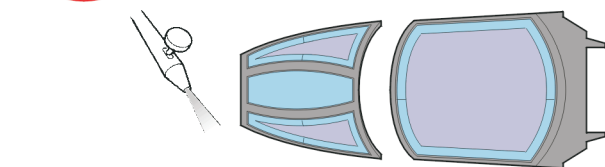

4.) **RUBBER COLOR**

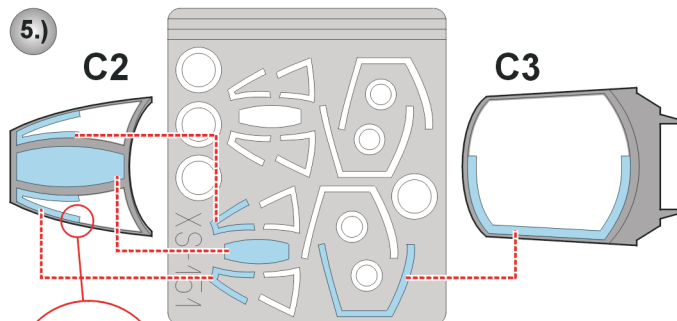
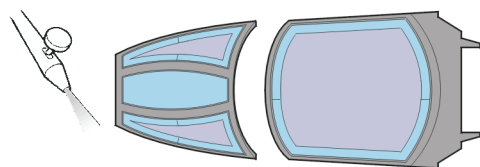

7.) **CAMOUFLAGE COLOR**

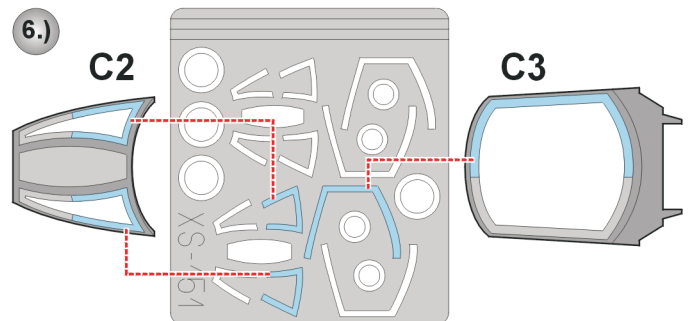
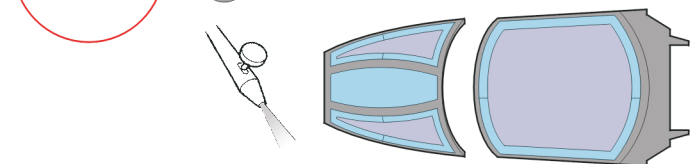

8.) **REMOVE MASK**

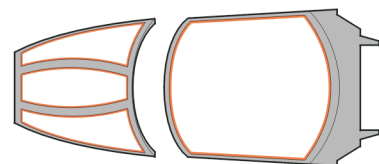

LIQUID MASK