

eduard
Express Mask

XS 145

F-111 Aardvark

The die-cut mask for accurate canopy frame painting of the
Hasegawa 1/72 KIT

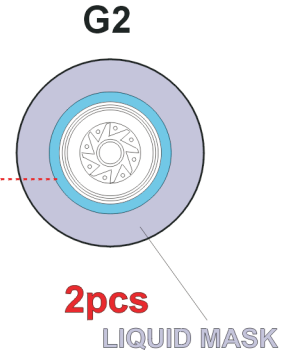
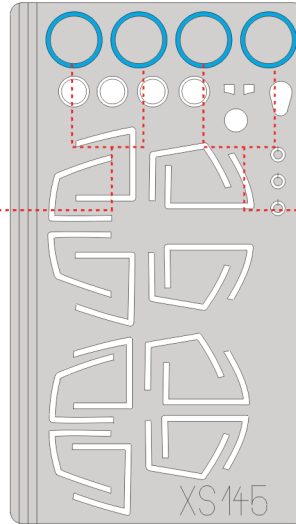
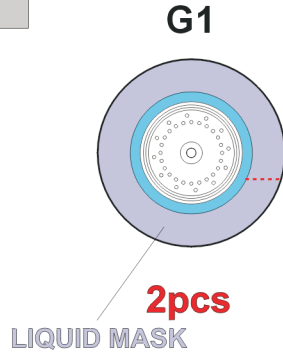
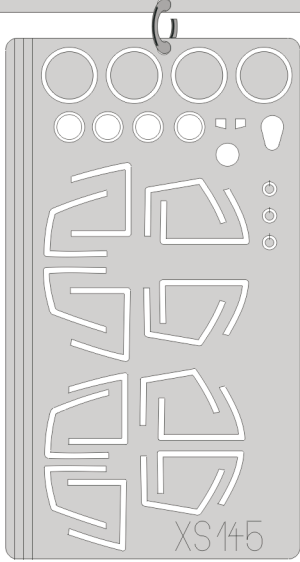

REFERENCES:
AEROQUIDE # 22

LOCK ON N° 5
(VERLINDEN PUBLICATIONS)

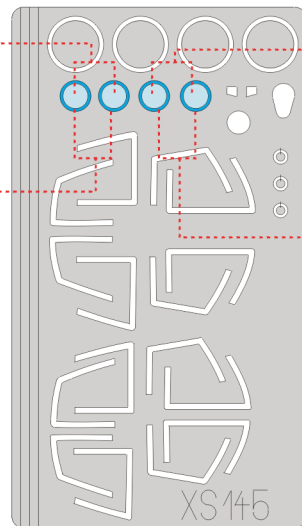
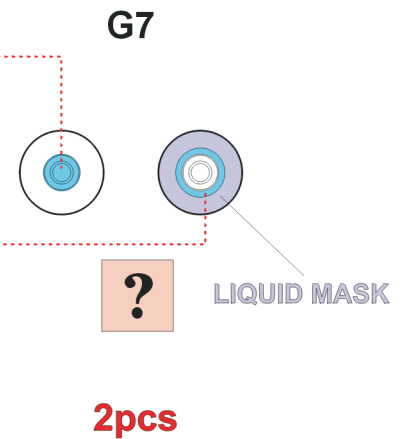
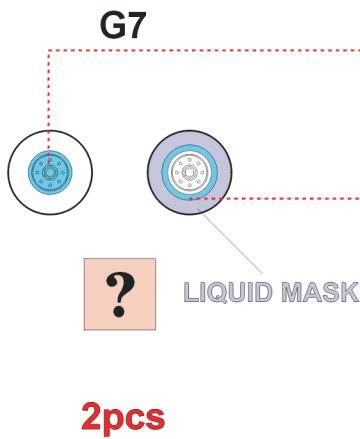
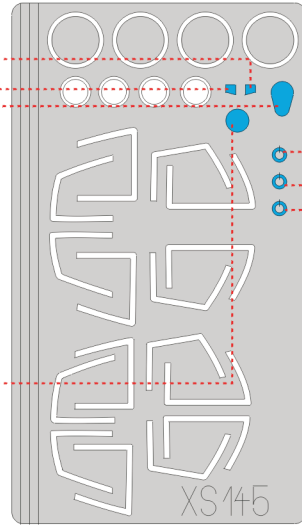
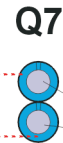
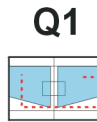

1.)

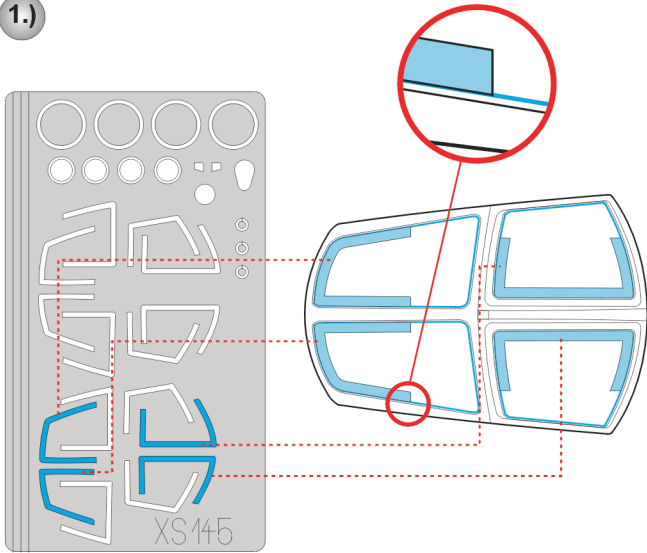

2.)

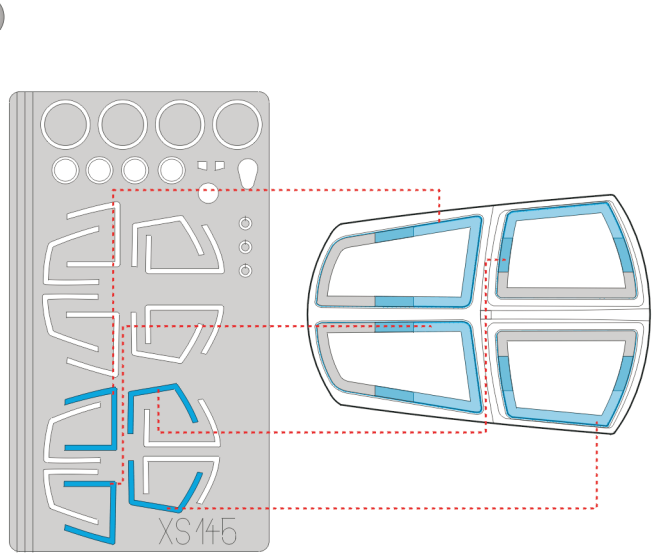

3.)

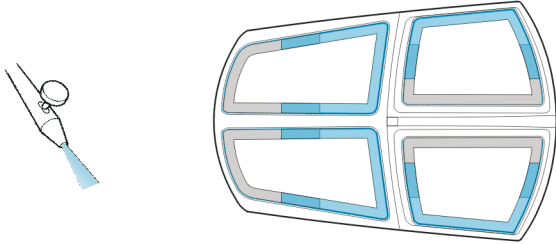

INTERIOR COLOR

4.)

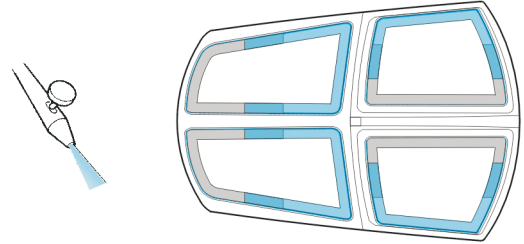

RUBBER COLOR

5.)

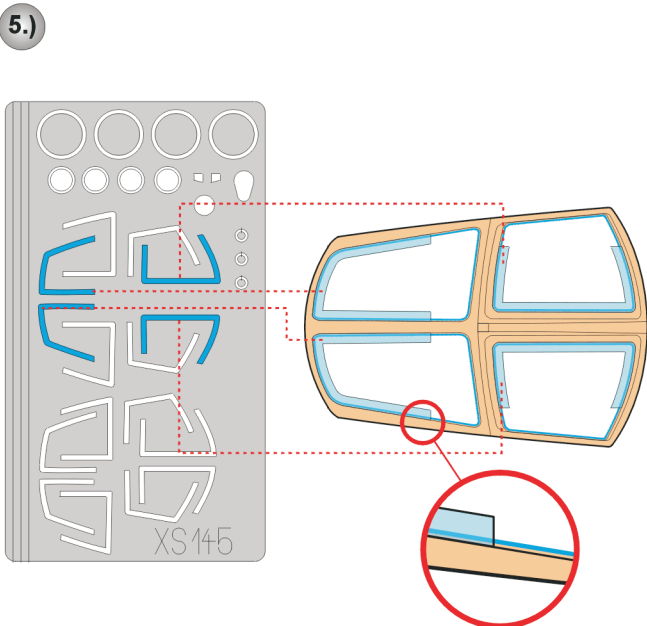

6.)

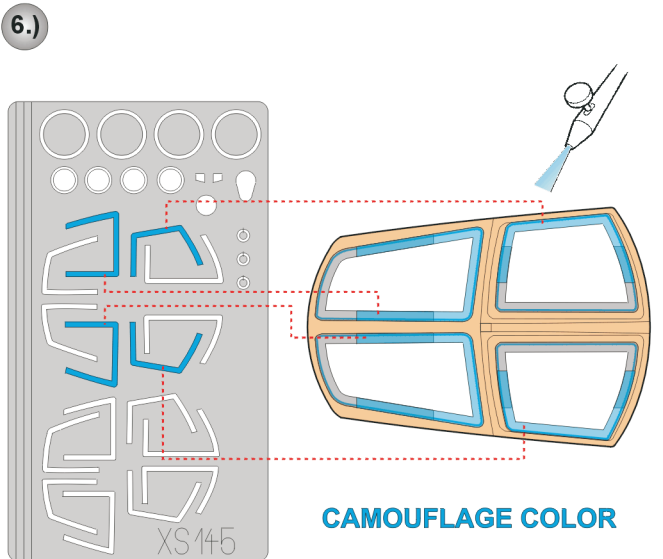

CAMOUFLAGE COLOR