

**eduard**  
**Express Mask**

# G3M Nell

The die-cut mask for accurate canopy frame painting of the  
*Hasegawa 1/72 KIT*

## XS 120

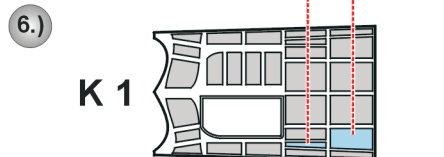
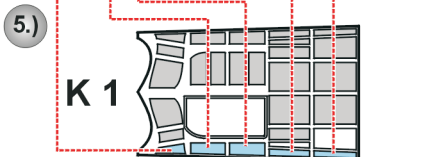
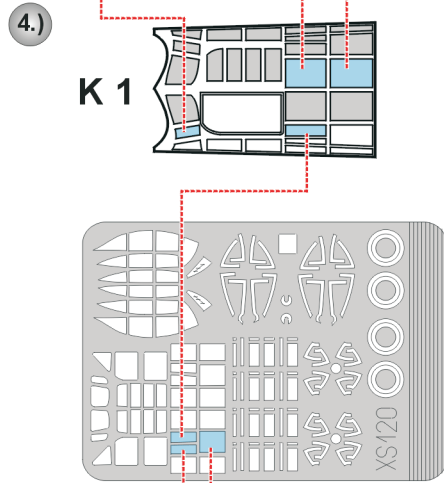
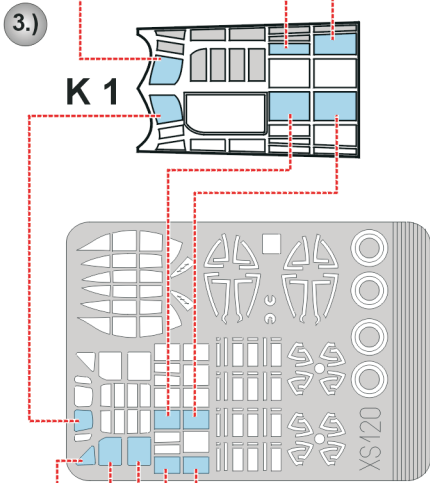
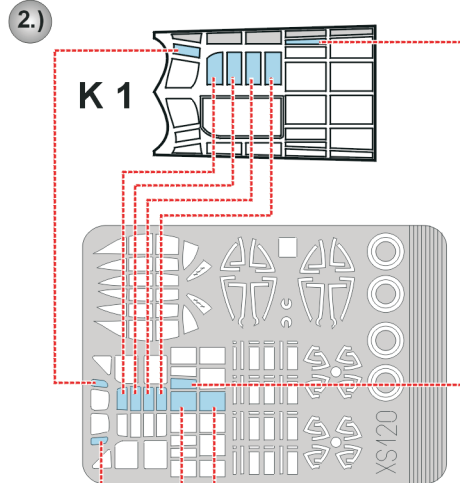
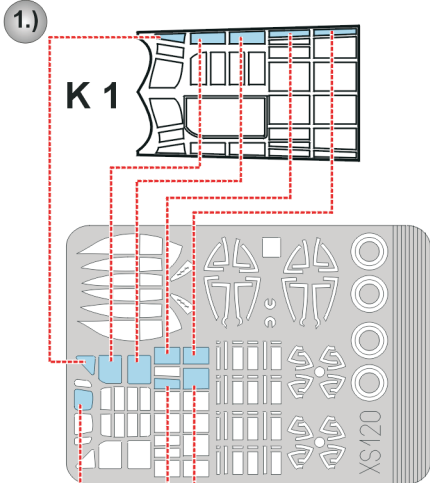
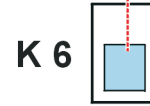
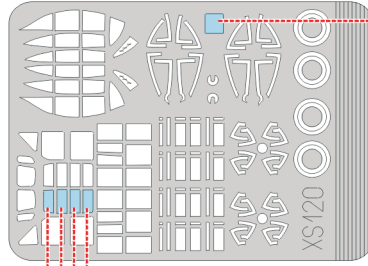
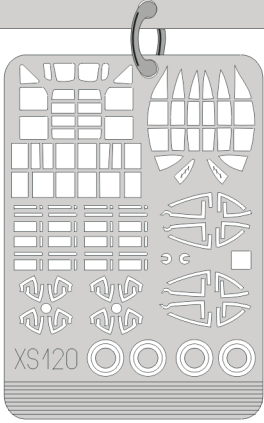

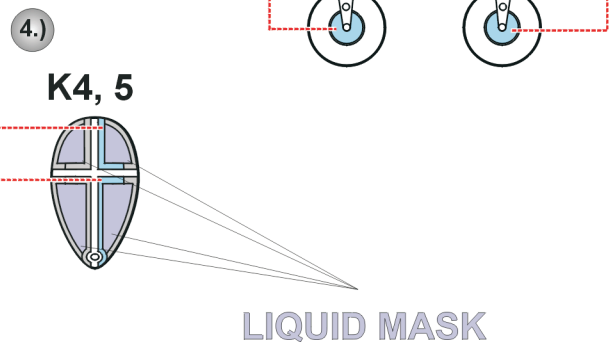
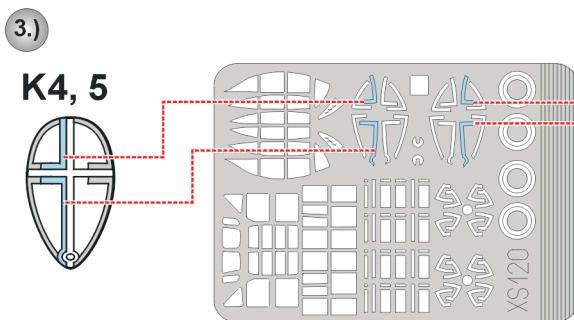
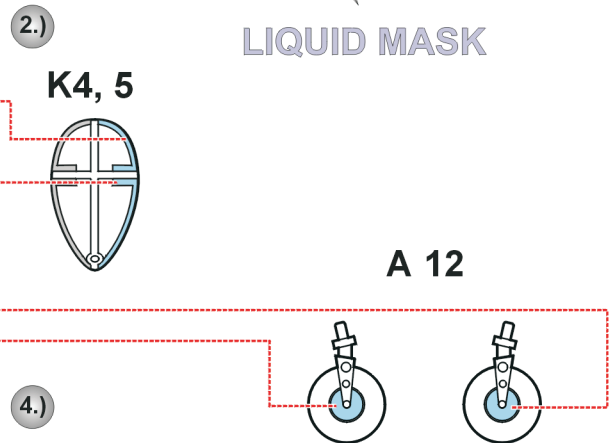
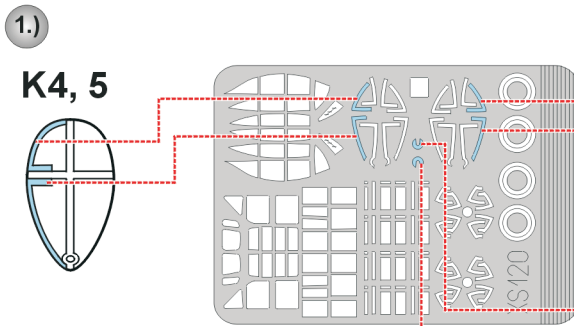
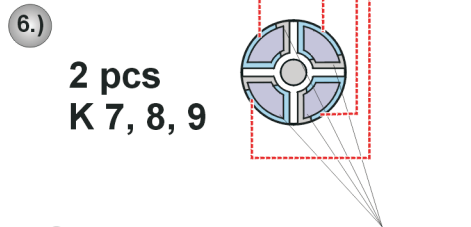
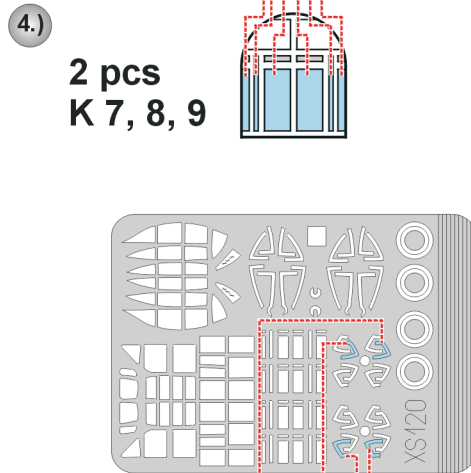
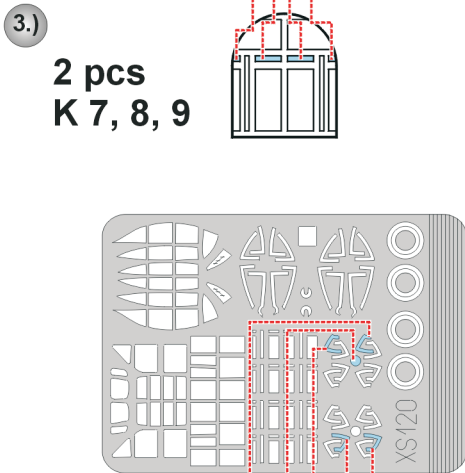
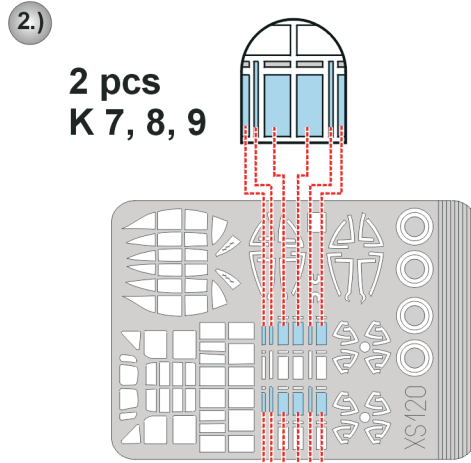
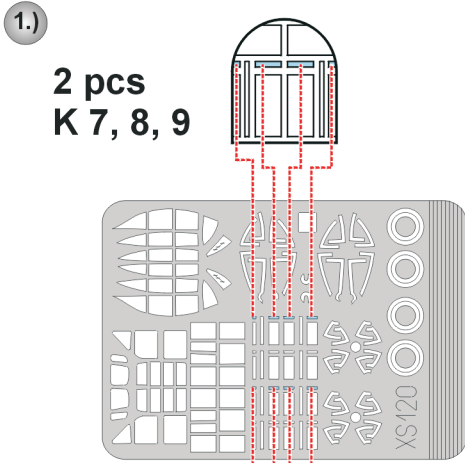

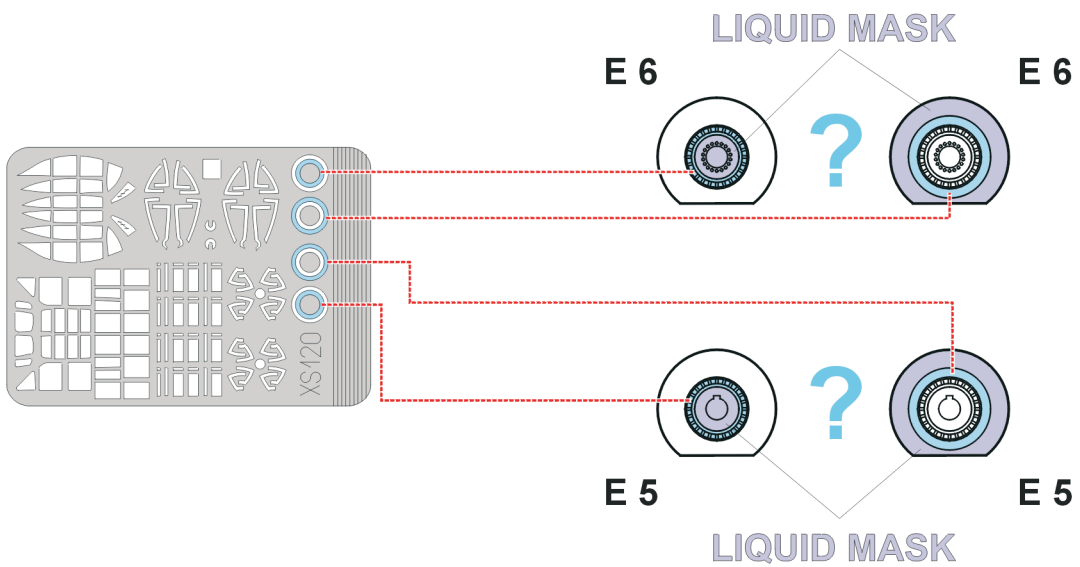
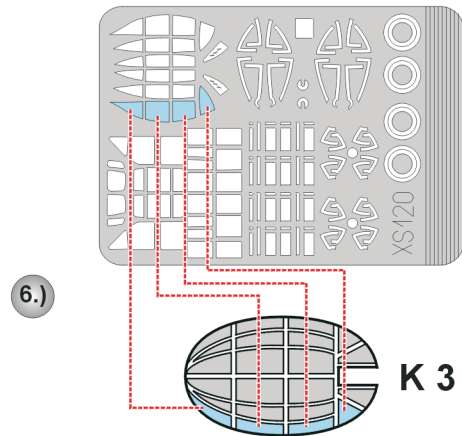
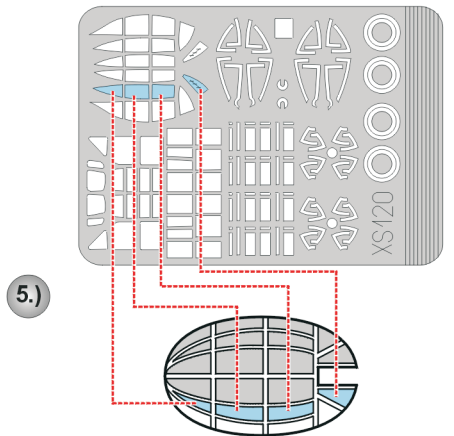
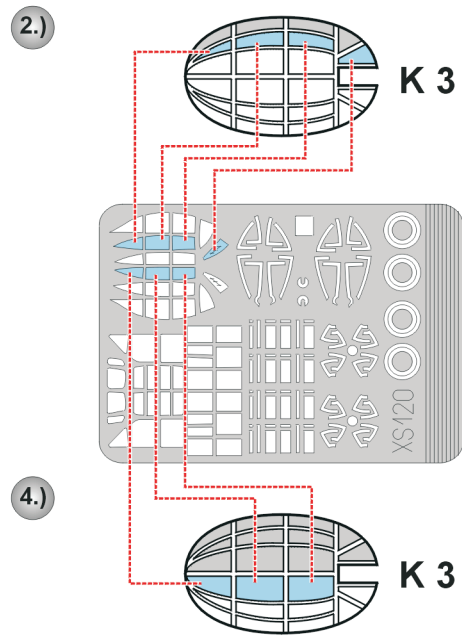
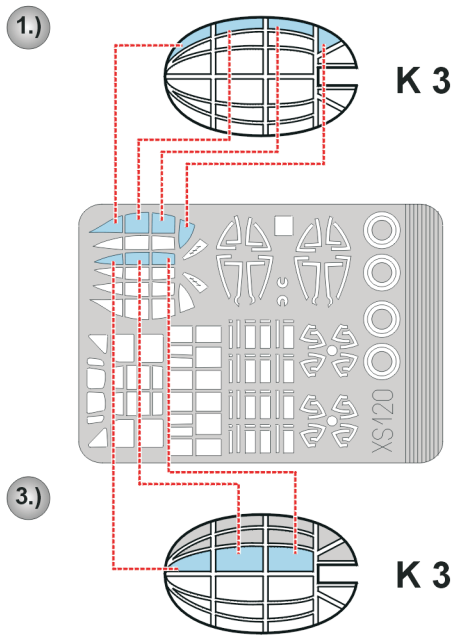

**REFERENCES:** Aircam Aircraft Series Mitsubishi: Nakajima G3M1/2/3, Lusho L3Y1/2 #35  
 Profile Publications: Mitsubishi G3M Nell Profile #160  
 Schiffer Books: Mit/ Nak G3M 96 Rikko