

eduard
MASK

Bf-109G-6

The die-cut mask for accurate canopy frame painting of the
Hasegawa 1/32 KIT

JX 007

LIQUID MASK ■

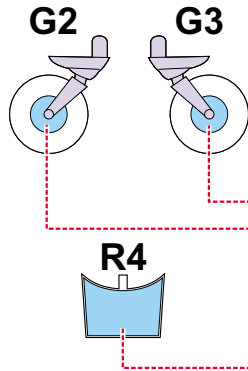

2pcs
M25

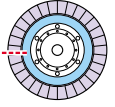

2pcs
M26

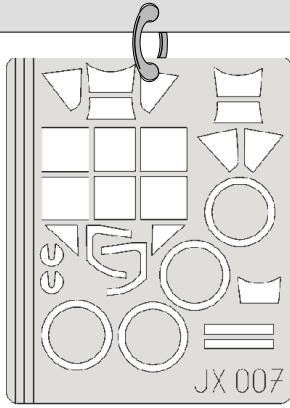
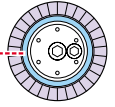

LIQUID MASK ■

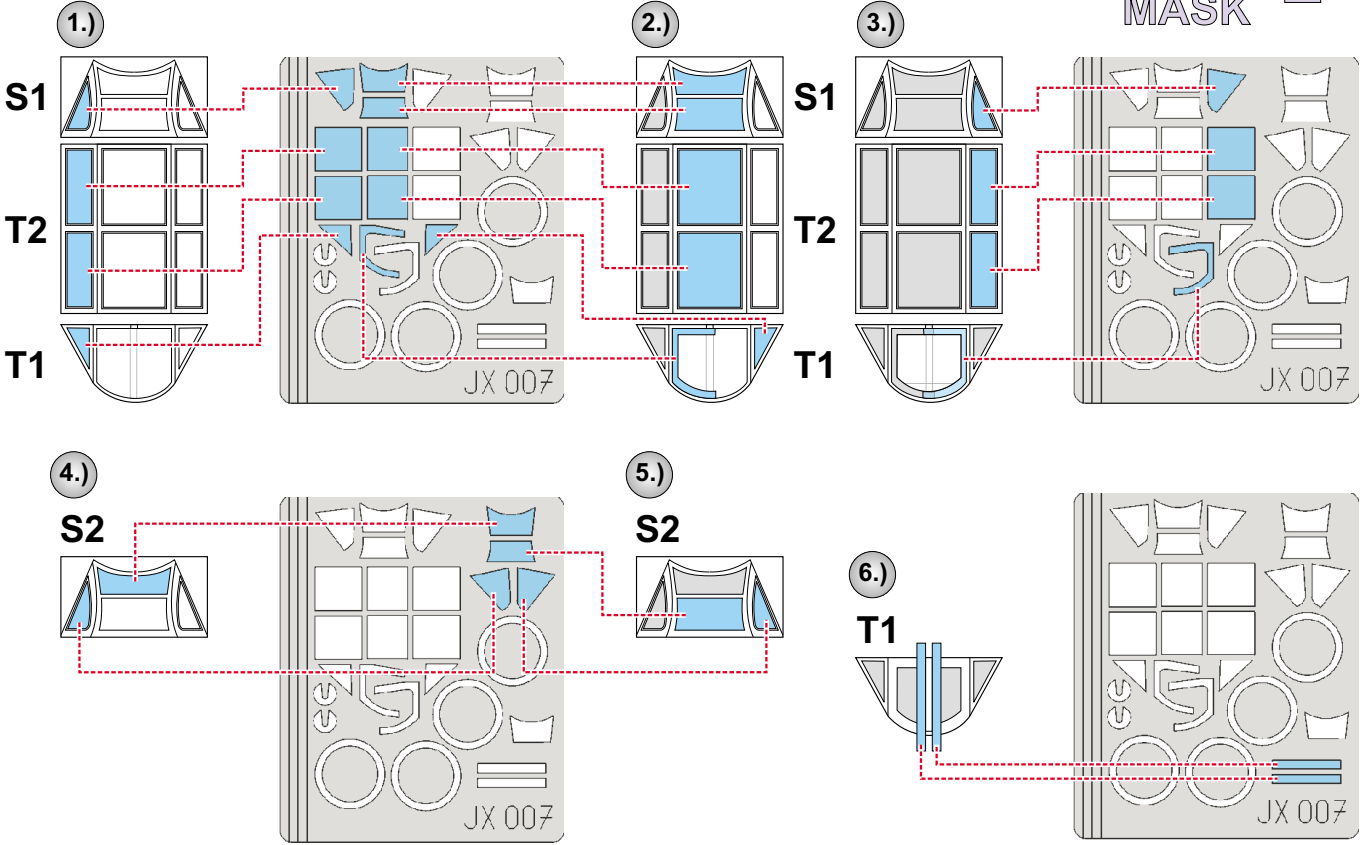

7.)  INTERIOR COLOR

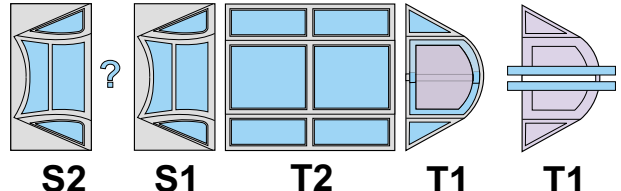

8.)  CAMOUFLAGE COLOR

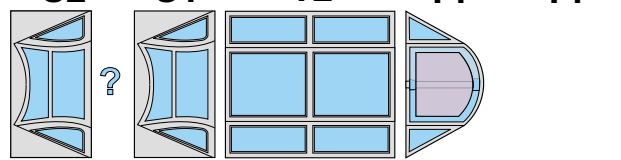

LIQUID MASK ■

REFERENCES: Aero Detail #5 - Messerschmitt Bf109G