

eduard  
MASK

# Ar 234C Blitz 1/48

The die-cut mask for accurate canopy frame painting of the  
*Revell*  
scale 1/48 KIT

## EX 121

LIQUID MASK ■

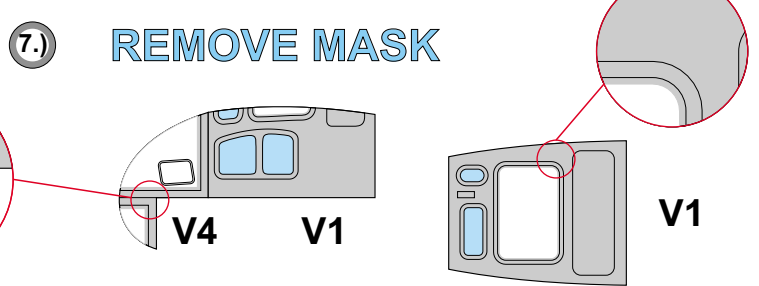
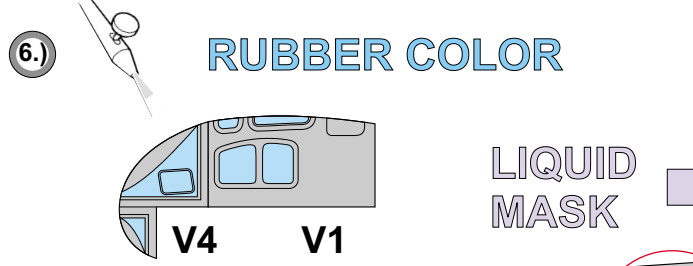
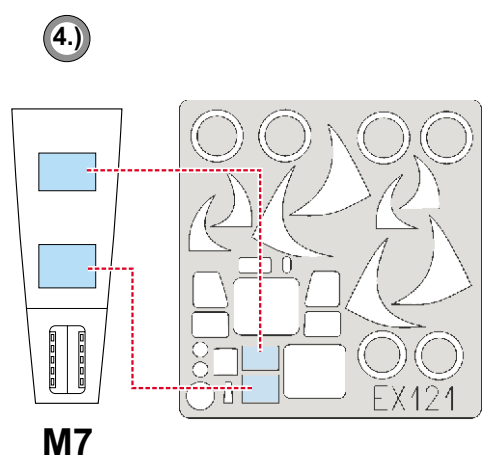
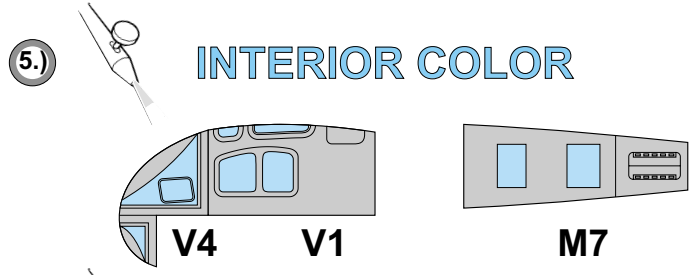
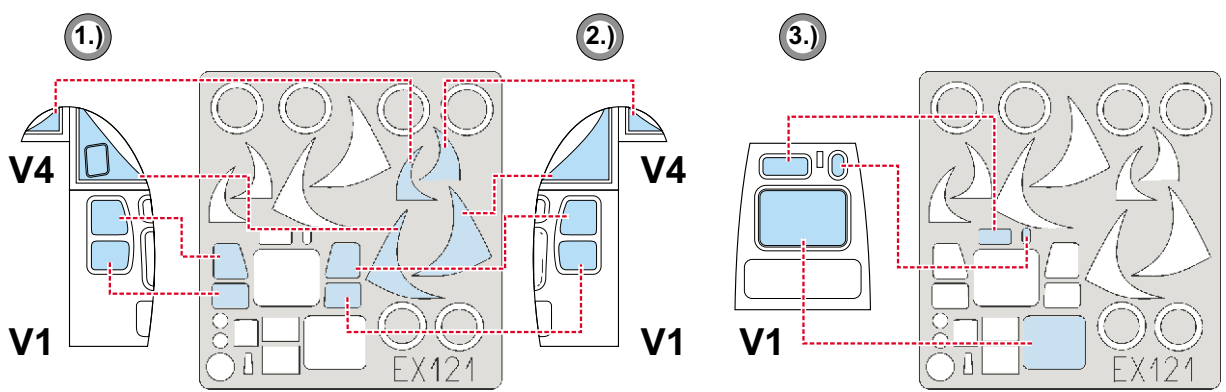
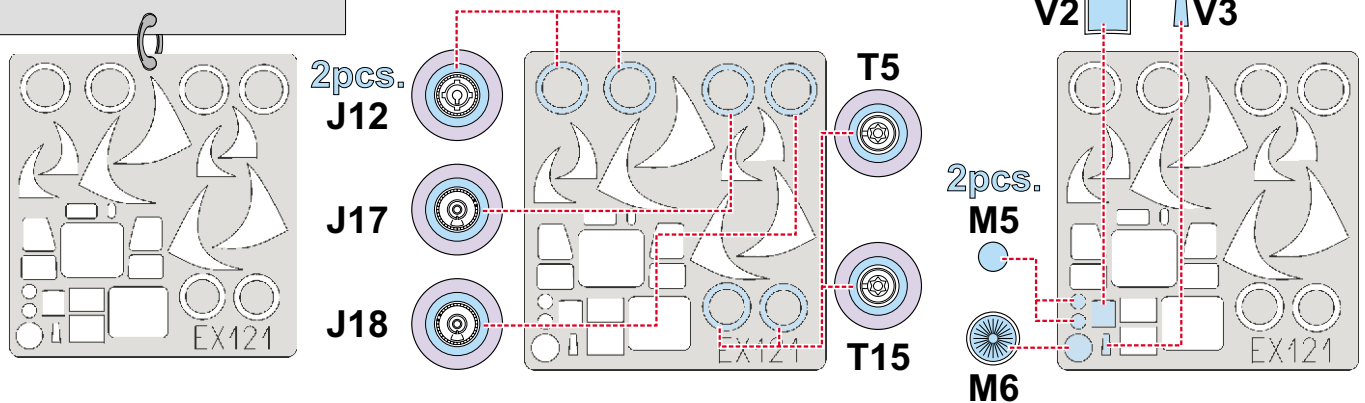

8.)

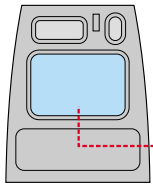

V1

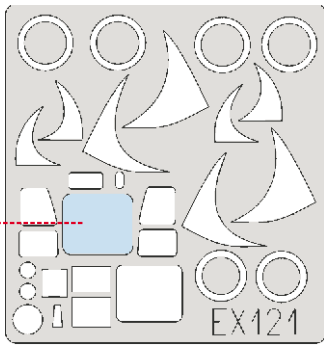

9.)

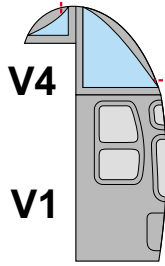

V4

V1

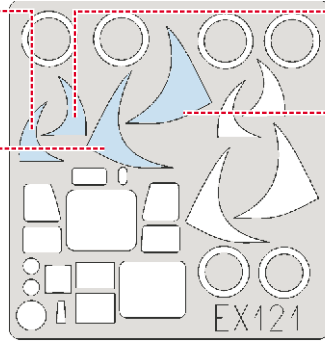

10.)

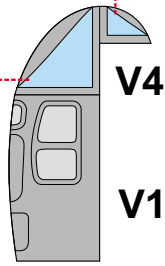

V4

V1

11.)

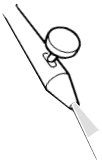

### CAMOUFLAGE COLOR

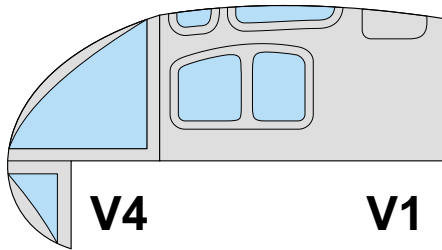

V4

V1

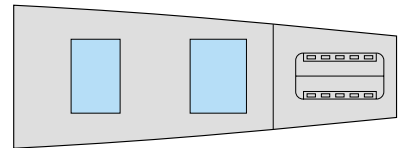

M7

LIQUID MASK

12.)

### REMOVE MASK

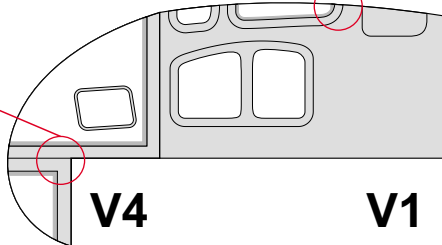
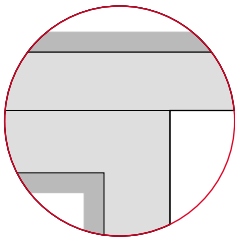

V4

V1

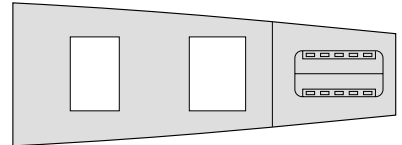
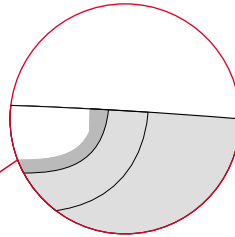

M7