

eduard
MASK

G3M Nell 1/72

The die-cut mask for accurate canopy frame painting of the
Hasegawa scale 1/72 KIT

CX 114

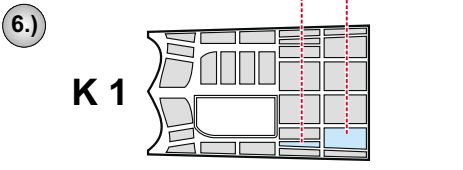
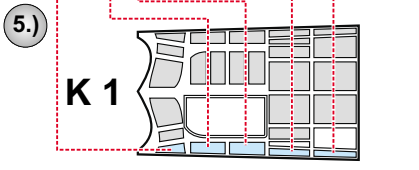
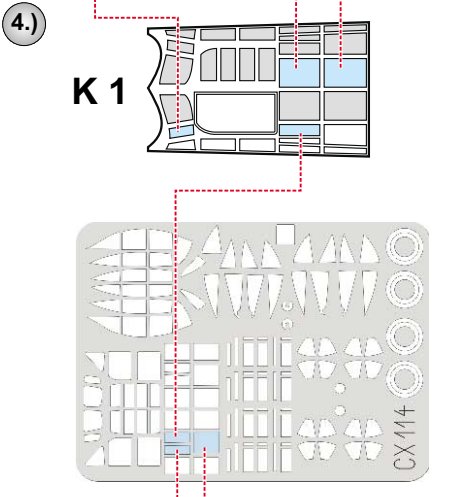
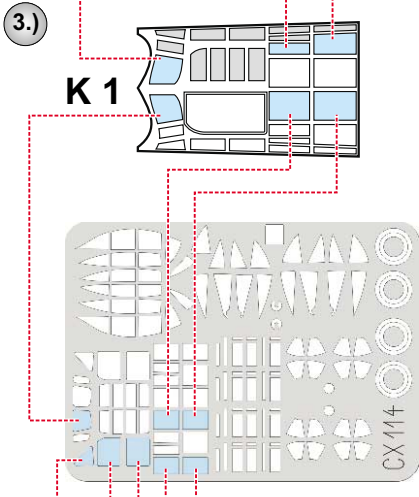
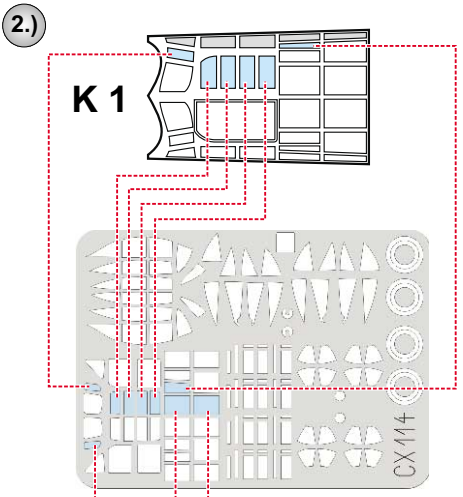
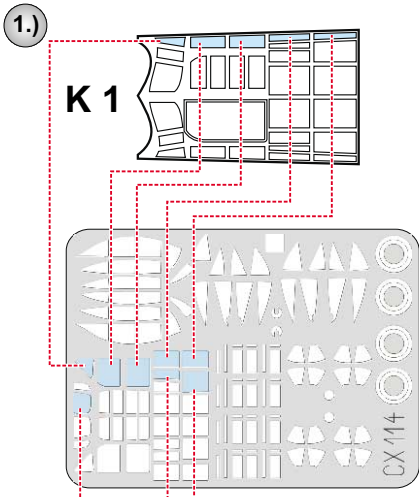
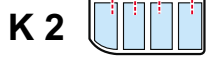
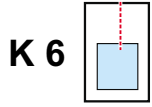
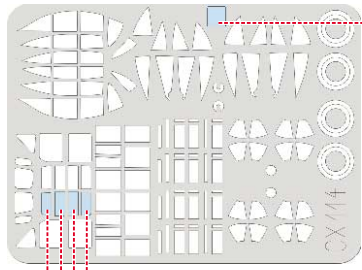
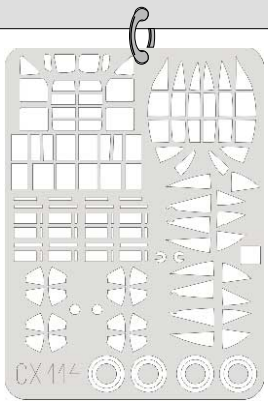

1.)

2 pcs
K 7, 8, 9

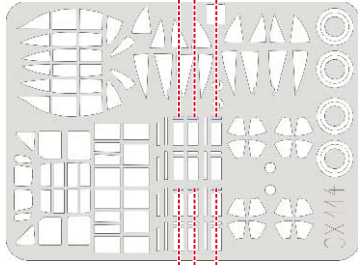
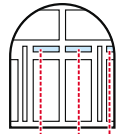

2.)

2 pcs
K 7, 8, 9

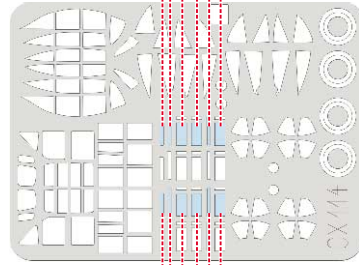
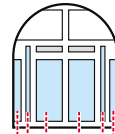

3.)

2 pcs
K 7, 8, 9

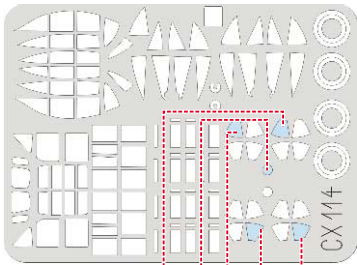
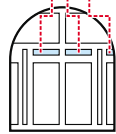

4.)

2 pcs
K 7, 8, 9

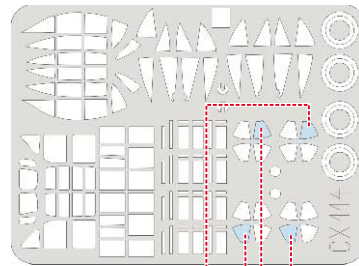
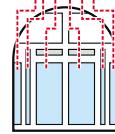

5.)

2 pcs
K 7, 8, 9

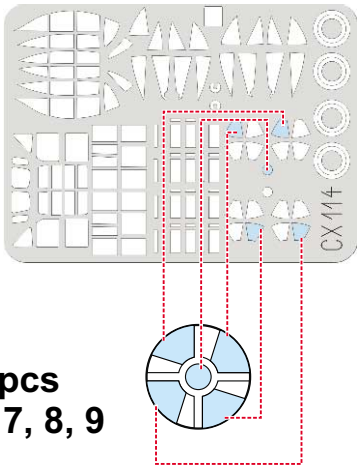
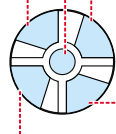

6.)

2 pcs
K 7, 8, 9

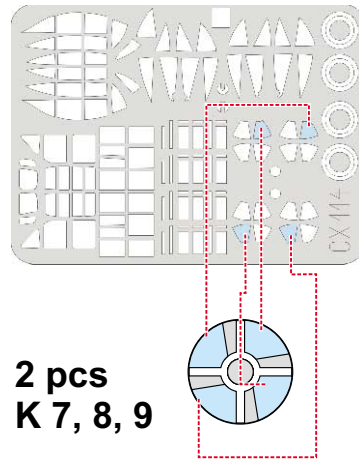
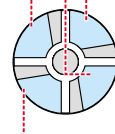

1.)

2 pcs
K4, 5

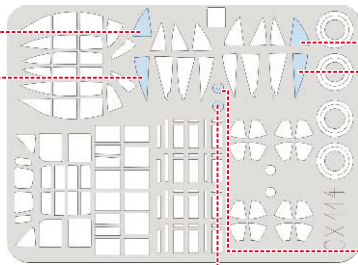
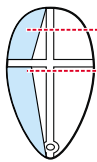

2.)

2 pcs
K4, 5

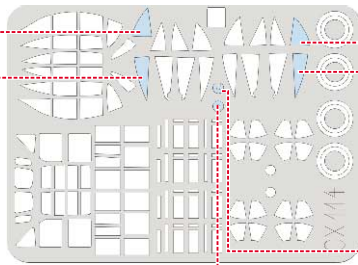
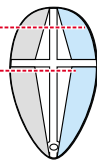

A 12

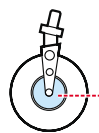
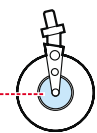

3.)

2 pcs
K4, 5

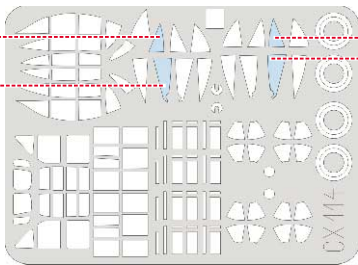
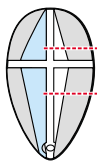

4.)

2 pcs
K4, 5

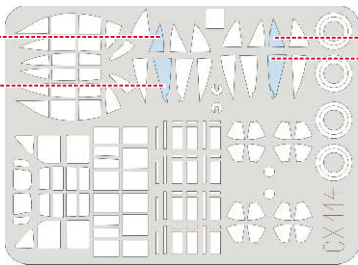
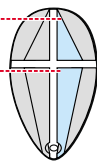

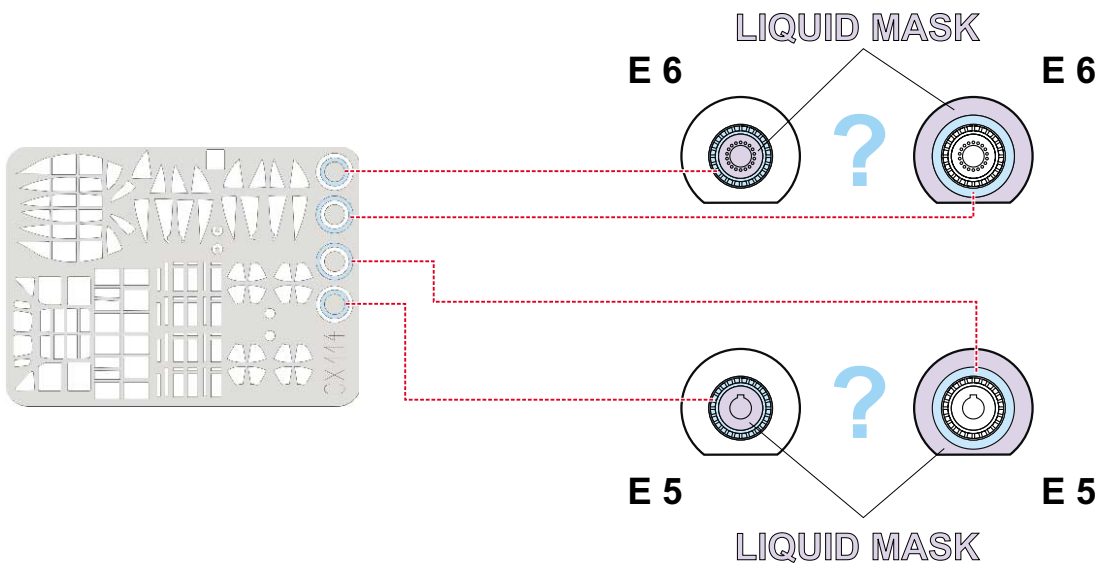
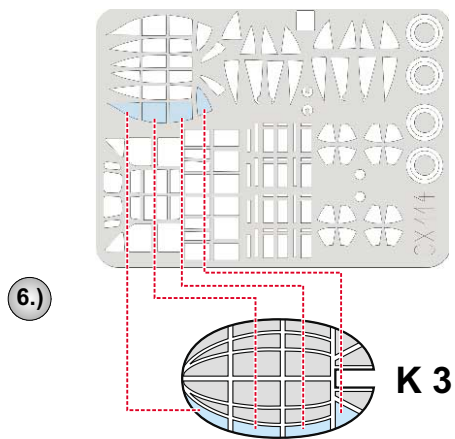
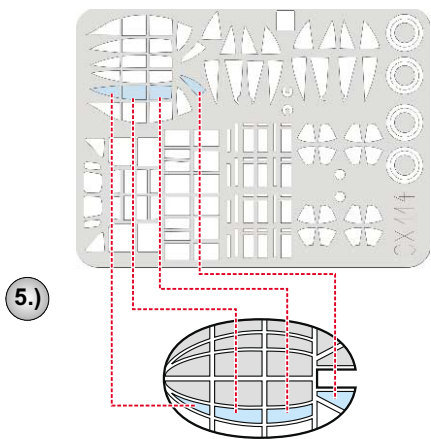
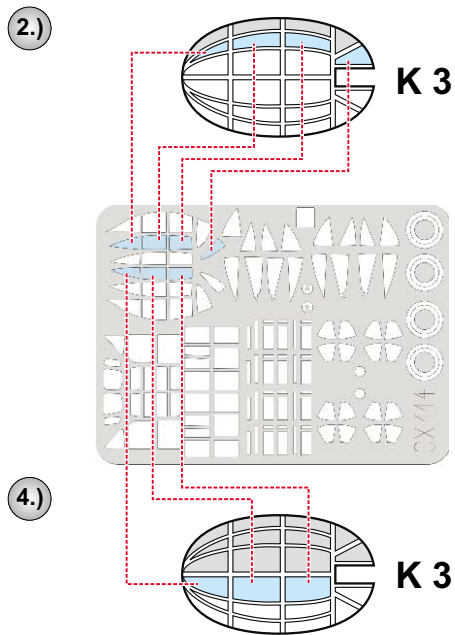
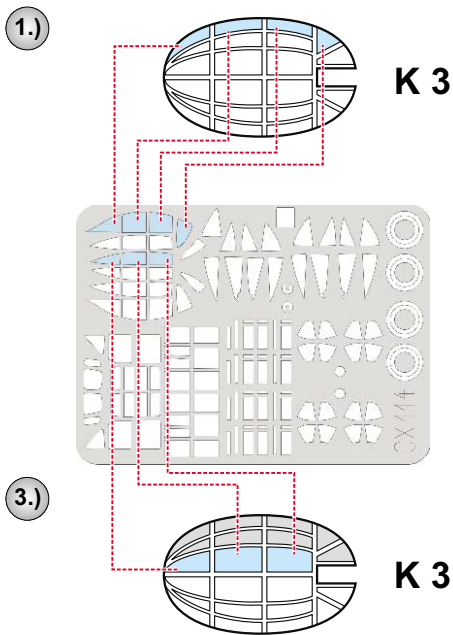

REFERENCES: Aircam Aircraft Series Mitsubishi: Nakajima G3M1/2/3, Lusho L3Y1/2 #35
 Profile Publications: Mitsubishi G3M Nell Profile #160
 Schiffer Books: Mit/ Nak G3M 96 Rikko