

WGr.21 for Bf 109

REMOVE ODSTRANIT	BEND OHNOUIT	SYMMETRICAL ASSEMBLY SYMETRICKÁ MONTÁŽ
GRIND OBROUSIT	OPTION VOLBA	SCRIBE THE PANEL AND HOLES RYTÍ
DRILL HOLE VRTAT OTVOR	REPLACE NAHRADIT	REVERSE SIDE OTOČIT

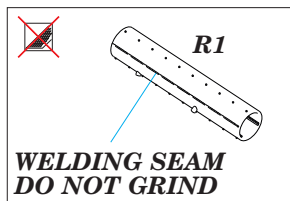

1

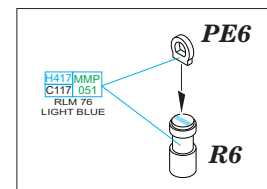
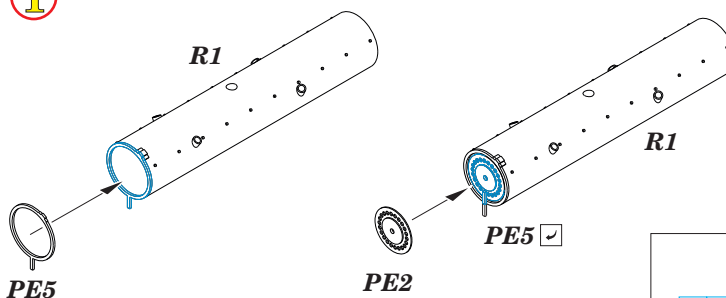

2

TEMPLATE

PE4

! DO NOT GLUE

! DO NOT GLUE

PE4

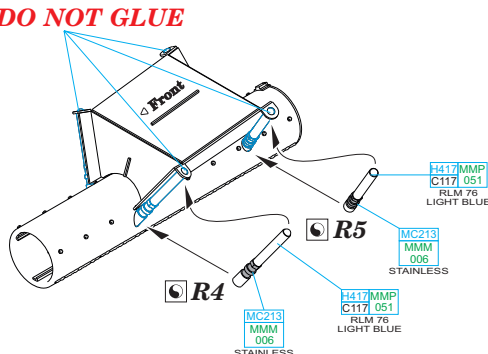
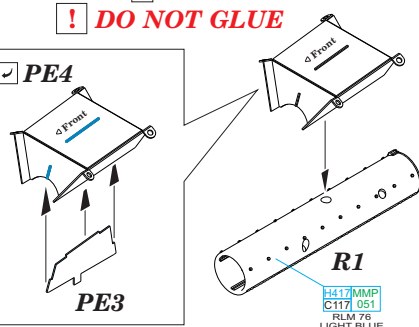

4

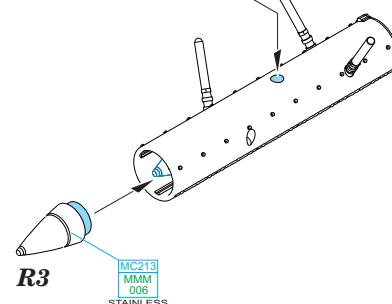

5

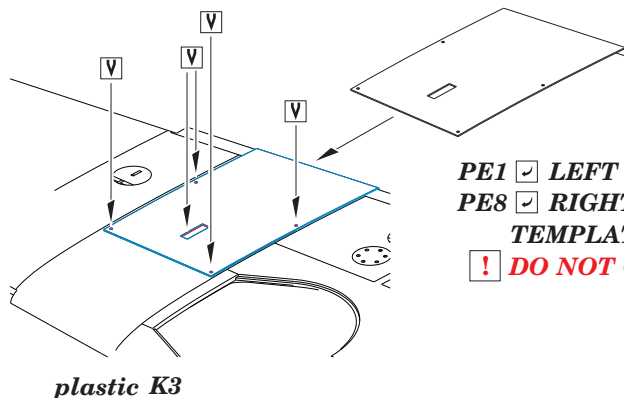

PE1 LEFT SIDE
PE8 RIGHT SIDE
TEMPLATE
! DO NOT GLUE

6

Ø - 0,6mm

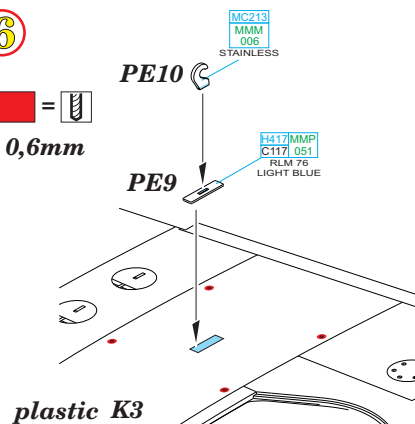

8

DIRECTION
OF FLIGHT

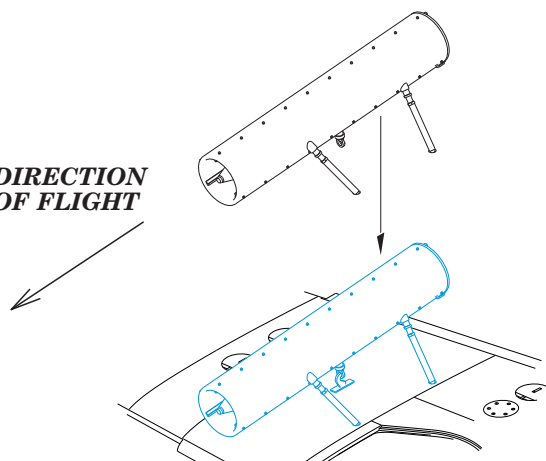

9

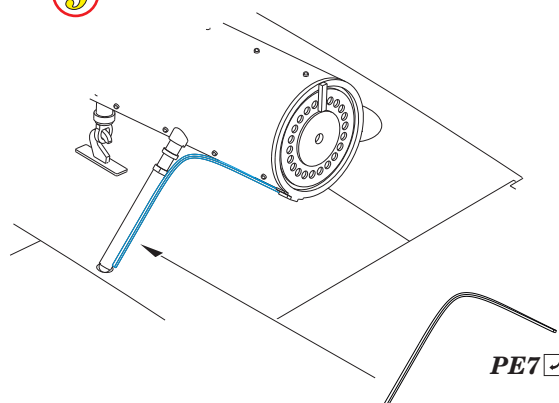

RLM 76 H417/MMP C117 051 STEEL MC213 MMM 006

eduard

BFC 055 - NAV1

WGr.21 for Bf 109

CORRECT POSITION

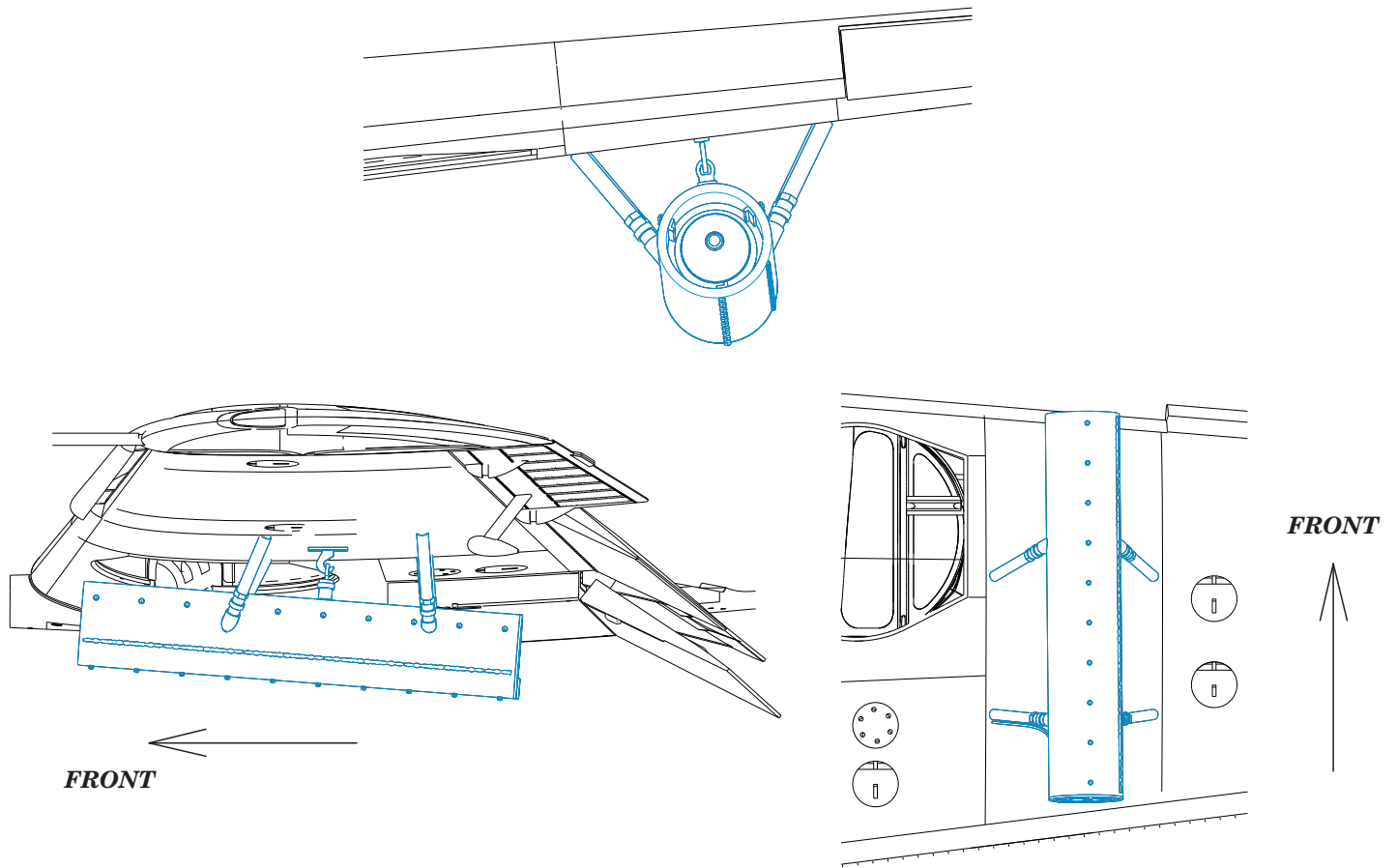

eduard

BFC 055 - NAV1

Bf 109G-6, 7./ JG 3, Bad Wörishofen, Germany, October 1943

For the purposes of achieving as much destructive power against American four-engined heavy bombers as possible, Bf 109 and Fw 190 interceptors were armed with high calibre weapons. Some were equipped with W.Gr.21 rocket pods which had their beginnings in the Nebelwerfer 42 launch tube system used by the Wehrmacht. The Messerschmitt Bf 109G-6 carried one W.Gr.21 launch tube under each wing. The rocket had a warhead weighing in excess of 40 kg and a range of 1200 m and was fired against the defensive boxes formed by the bombers. This Bf 109G-6 from the 7th Staffel JG 3 carries the Erla applied camouflage scheme at Leipzig. It also carried a stylised comet marking in white on a black background located over the MG 131 fairing.

