



Seatbelts USAAF WWII FABRIC

eduard

32 771

1/32 scale detail set for kit • sada detailů pro model 1/32

**PE -
PHOTOETCHED
PART**



**TP -
TEXTILE
PART**

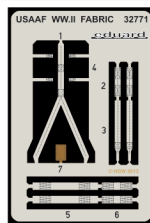

- | | | | |
|--|--|--|---------------------|
| | APPLY EXPRESS MASK AND PAINT BEFORE GLUING
POUŽIT EXPRESS MASK NABARVIT PŘED SLEPENÍM | | BEND
OHNOUT |
| | SYMMETRICAL ASSEMBLY
SYMETRICKÁ MONTÁŽ | | OPTION
VOLBA |
| | REMOVE
ODSTRANIT | | REPLACE
NAHRADIT |
| | GRIND
OBROUSIT | | |
| | DRILL HOLE
VRTAT OTVOR | | |

ORIGINAL KIT PARTS
PŮVODNÍ DÍLY STAVEBNICE

PHOTO-ETCHED PARTS
LEPTANÉ DÍLY

PARTS TO BE REMOVED
DÍLY K ODSTRANĚNÍ

FILL
TMELIT

1/2

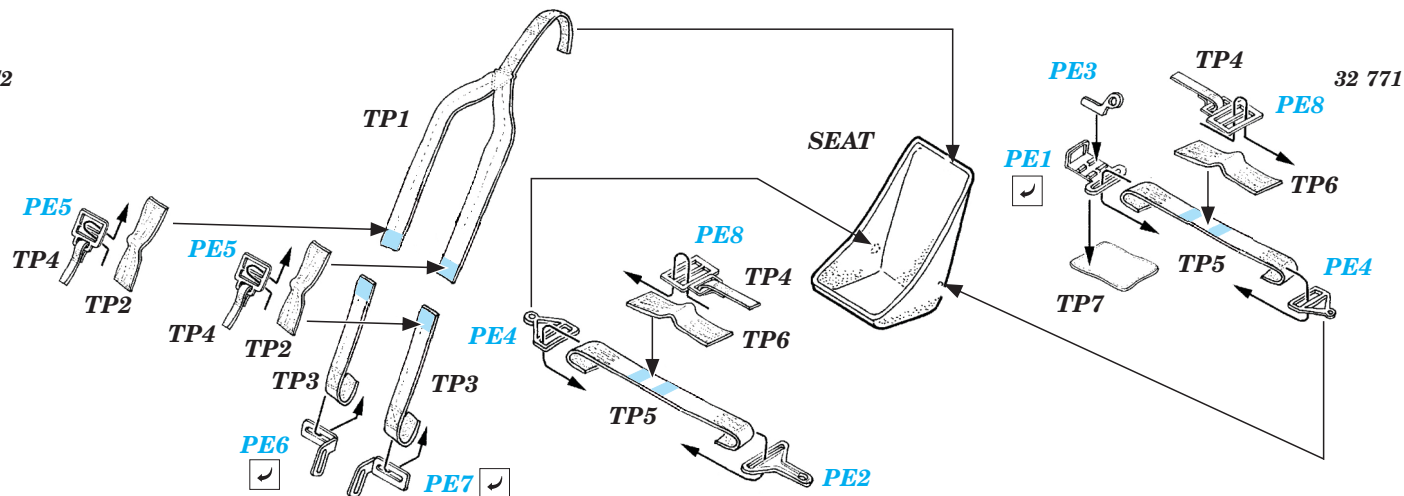

- 1. Take the precut textile part out of the sheet.**
- 2. Remove supporting paper.**
- 3. Crumple the belt into a little ball and nead it between the fingers.**
- 4. Thread the belts through the buckles - use superglue.**
- 5. Put the belts into the seat.**
- 6. Spray by the glossy varnish.**
- 7. Impregnate the belts with very diluted oil color (mix black and brown) - it will highlight the texture.**
- 8. Spray by matt varnish.**

After the varnish becomes dry it is possible to drybrush with light oil colour.