



# B-25 ammunition belts

1/32 scale detail set for HK Models kit • sada detailů pro model 1/32 HK Models

eduard

32 320

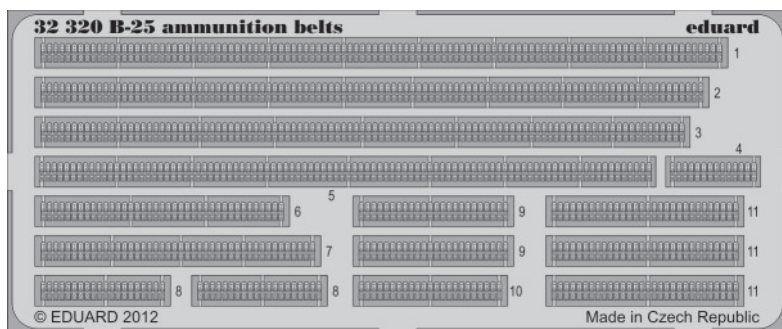

	APPLY EXPRESS MASK AND PAINT BEFORE GLUING POUŽIT EXPRESS MASK NABARVIT PŘED SLEPENÍM
	SYMMETRICAL ASSEMBLY SYMETRICKÁ MONTÁŽ
	REMOVE ODSTRANIT
	GRIND OBROUSIT
	DRILL HOLE VRTAT OTVOR
	BEND OHNOUT
	OPTION VOLBA
	REPLACE NAHRADIT

ORIGINAL KIT PARTS  
PŮVODNÍ DÍLY STAVEBNICE

PHOTO-ETCHED PARTS  
LEPTANÉ DÍLY

PARTS TO BE REMOVED  
DÍLY K ODSTRANĚNÍ

FILL  
TMELIT

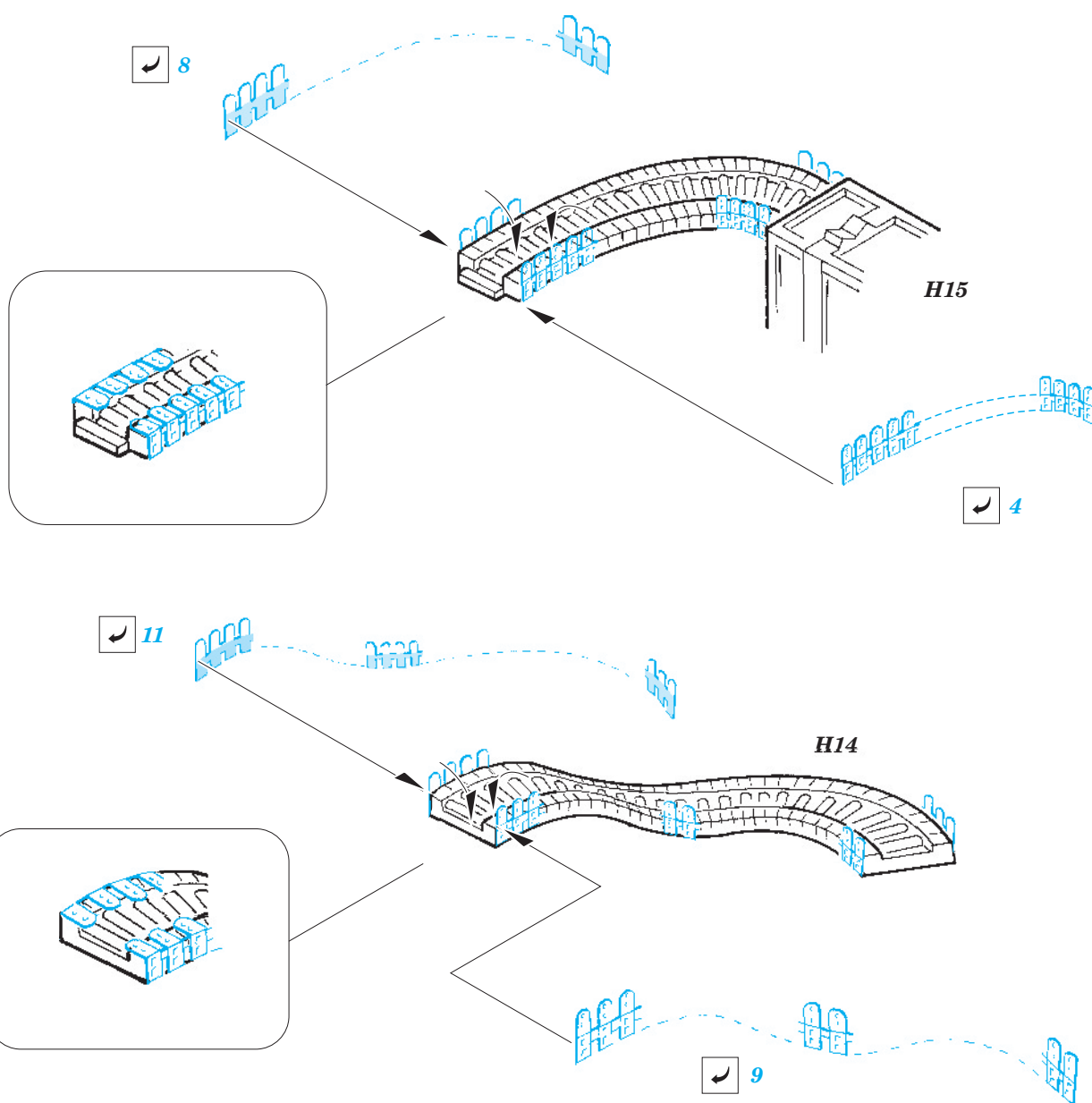

*kit part H18..... 9, 11*

*kit part I12..... 3, 5*

*kit part I13..... 1, 2*

*kit part I14..... 6, 7*

*kit part I15..... 8, 10*

*For further detail sets look for **eduard** 32 748 B-25J bomber cockpit interior (not included in this set)*

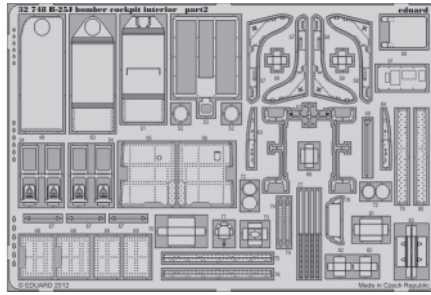
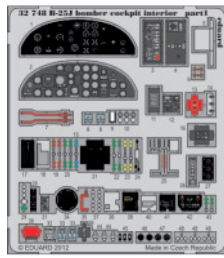

*For further detail sets look for **eduard** 32 747 B-25J bomber front interior (not included in this set)*

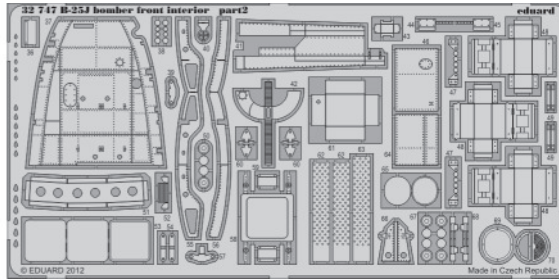
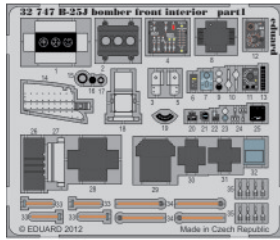

*For further detail sets look for **eduard** 32 746 B-25J seatbelts (not included in this set)*

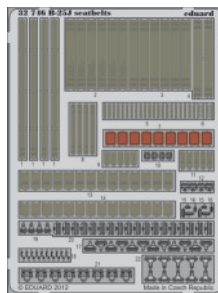

*For further detail sets look for **eduard** 32 321 B-25 bomb bay (not included in this set)*

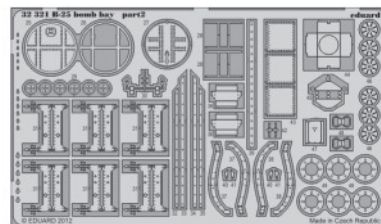
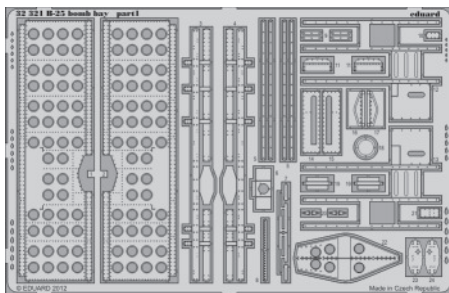

*For further detail sets look for **eduard** 32 750 B-25J correct pilot seats (not included in this set)*

