

eduard
Express Mask

Bf-110

The die-cut mask for accurate canopy frame painting of the
Revell 1/32 KIT

XL 030

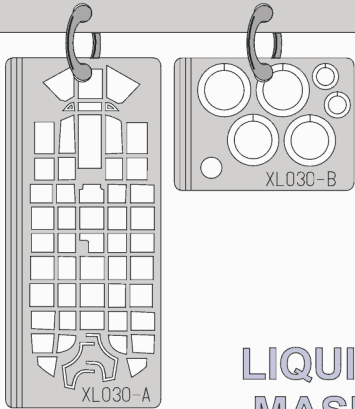

LIQUID MASK

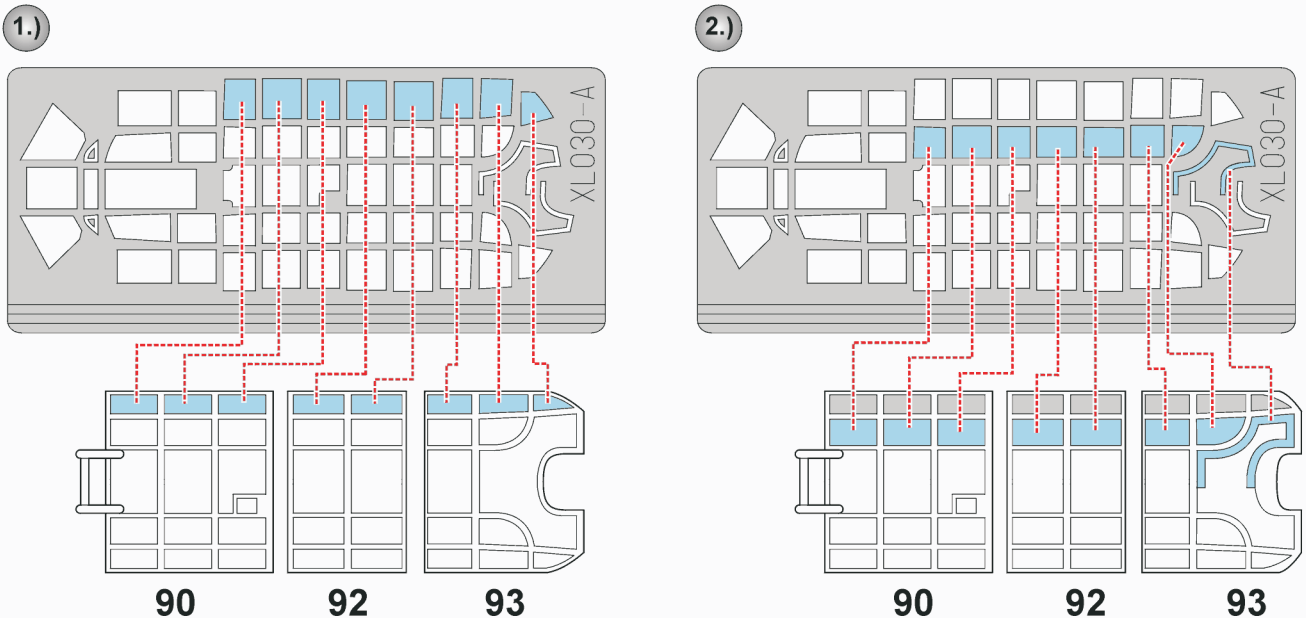
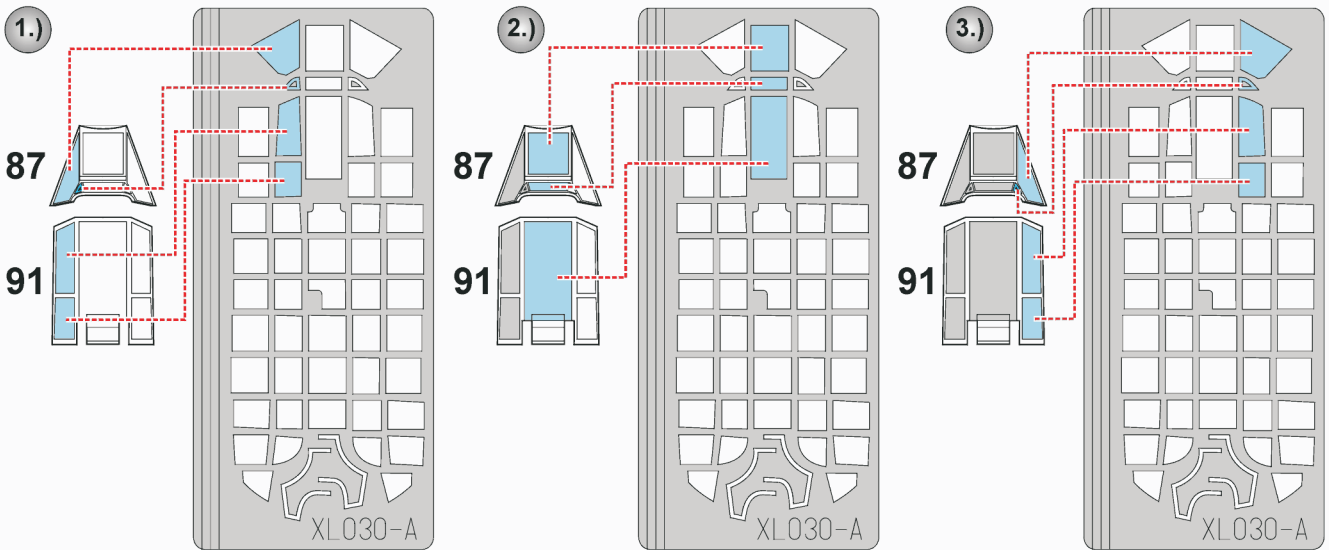
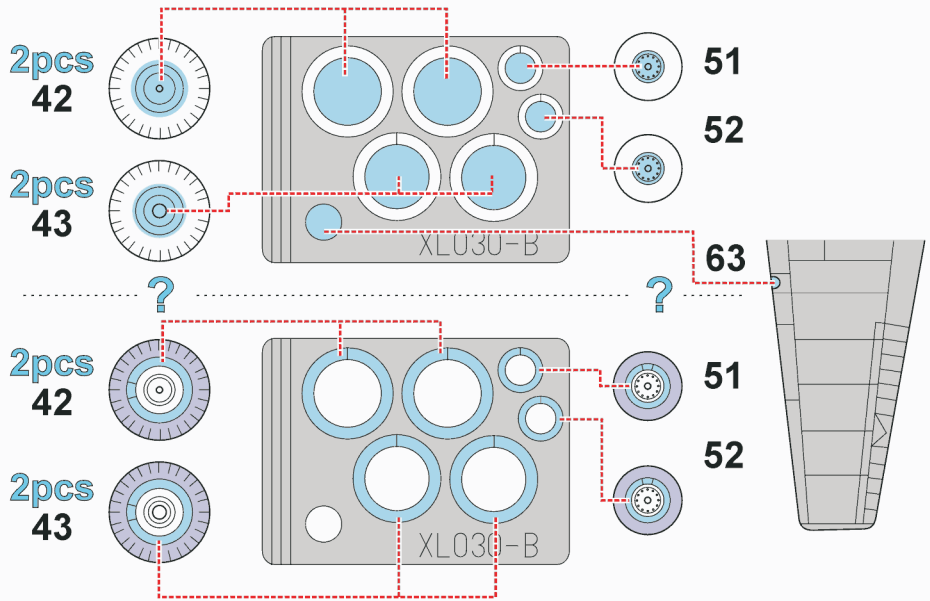

3.)

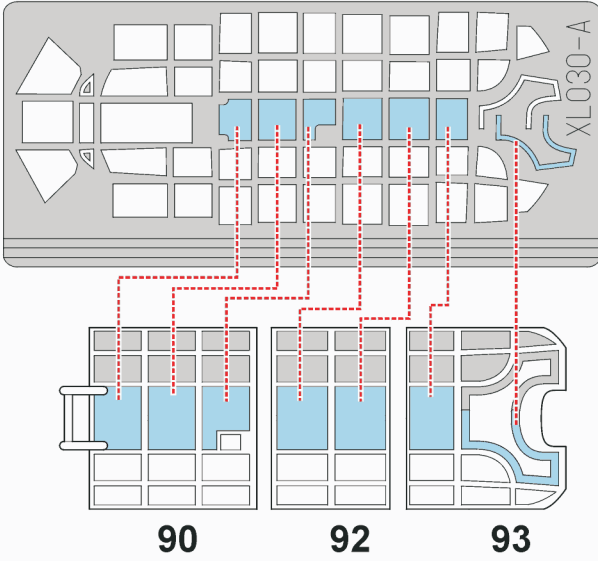

4.)

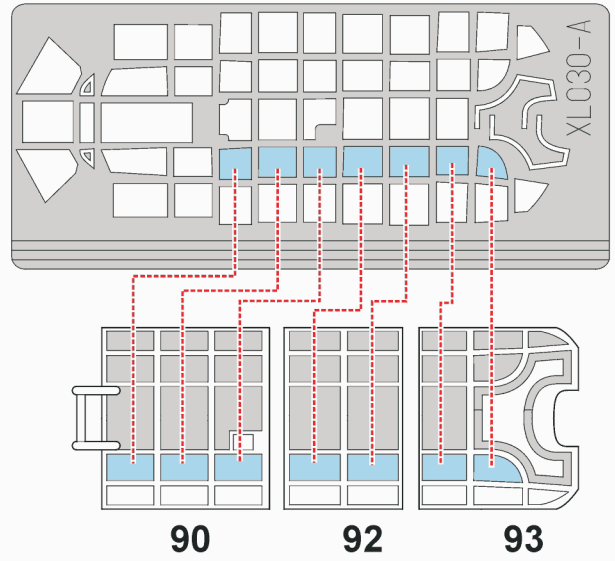

5.)

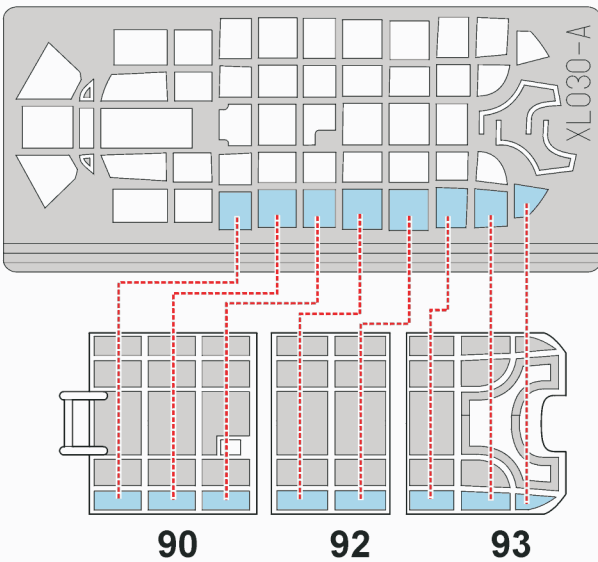

6.)

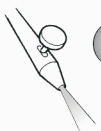
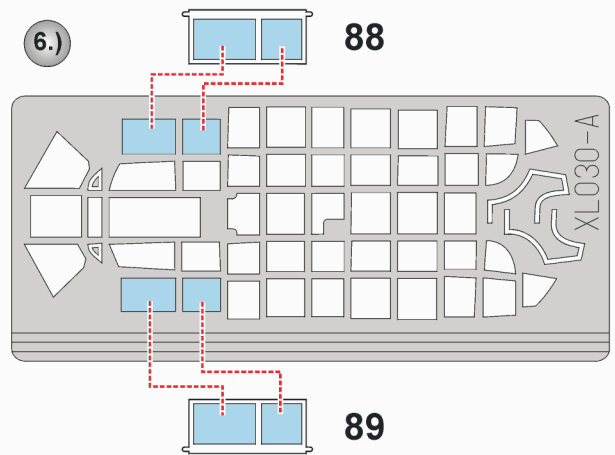

1.)

**INTERIOR
COLOR**

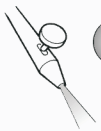
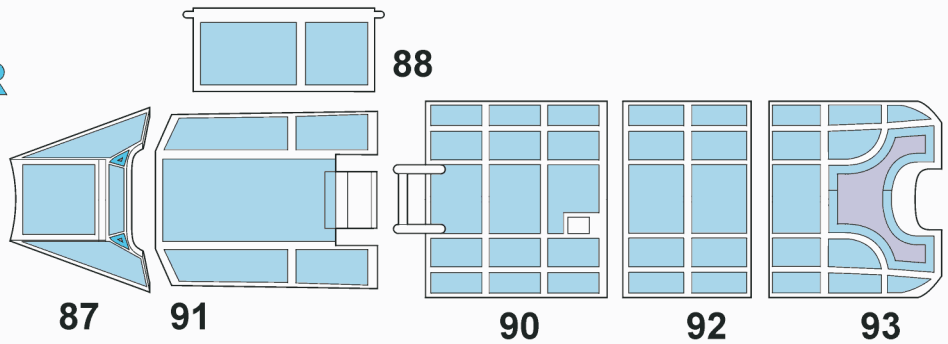

2.)

**CAMOUFLAGE
COLOR**

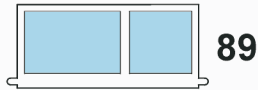

**LIQUID
MASK**

